

希臘、伊太利、獨佛、

第十三卷

希臘、伊太利、獨佛、
第十三冊

明治三十八年自二月
至四月

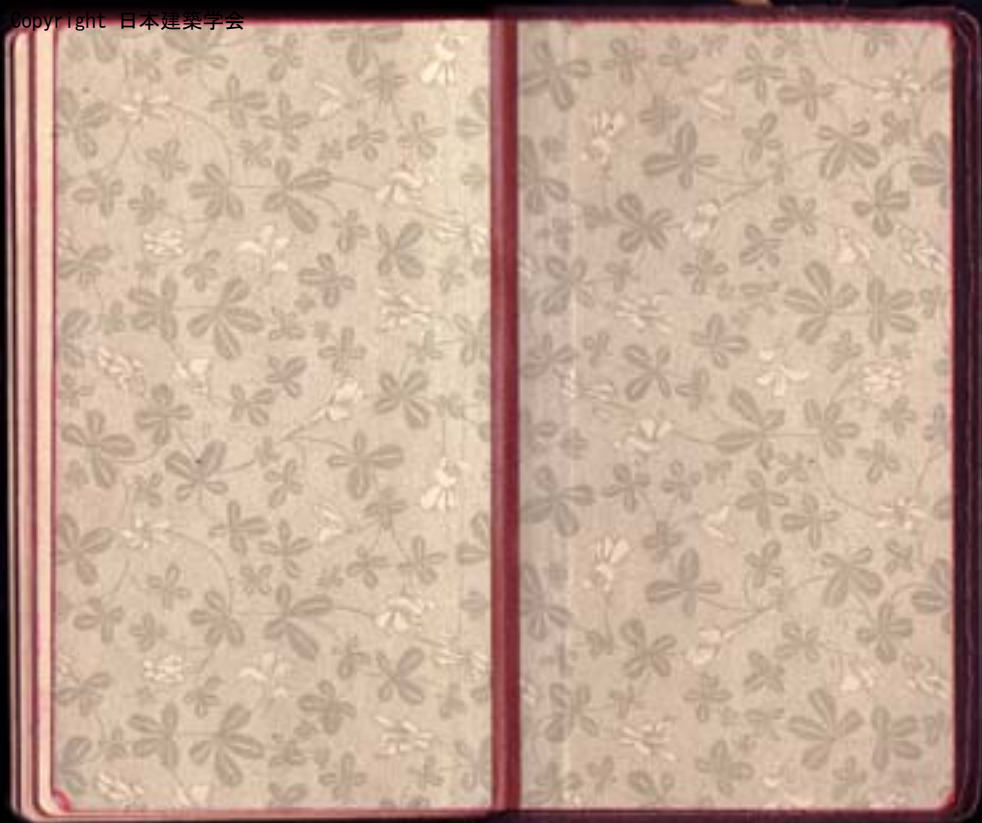

Book III.

Contents.

	page	
I. <i>Moran</i>	1.	
<i>Richmond</i>		
<i>Sandstone</i>		
<i>W. Hill</i>		大
<i>Curran Acropolis</i>		大
<i>Coleon</i>		大
<i>Wheat</i>		大
<i>Gales</i>		大
<i>Temple & Jupiter's Hill via</i>		大
<i>Government of Maryland</i>		大
<i>Law of</i>		大
<i>Political parties by railroad (cont.)</i>		
<i>National Museum</i>		
<i>State</i>		
<i>St. Anselm's (top - 1000)</i>		
<i>Case of Indian</i>		
<i>Part of year</i>		
<i>St. A.</i>		
<i>St. B. & Thomas</i>		
<i>St. C. Church</i>		
<i>St. D. 1000</i>		
<i>St. E.</i>		
<i>St. F.</i>		
<i>St. G. Guberville</i>		
<i>St. H.</i>		
<i>Philosophy</i>		



山下三城
 山下三城
 山下三城
 山下三城
 山下三城

小佐朝
 朝朝朝
 }大佐

Berlin. *Germany* 柏林
 柏林
 柏林

Kriminal (Kriminal)
 Berlin. *Germany* 柏林
 Berlin. *Germany* 柏林
 柏林
 柏林

	15	125		
	5	25		
	75	25		
	75	75		
	75	75		
	75	75		
St. B.	1	50	75	100
St. C.	100	20	50	80
St. D.	200	80	70	180
St. E.	100	30	60	80
St. F.	100	30	60	80
St. G.	100	30	60	80
		170	205	270

Contents (continued)

- II. Corinth
- III. Mycena
- IV. Olympia
- V. Pompeii
- VI. Napoli.
- VII. Roma
- VIII. Florence
- IX. Venice
- X. Verona
- XI. Milan
- XII. St. Gallen
- XIII. Basle and Umgebung
- XIV. Loure
- XV. Bonn
- XVI. London
- XVII. New York
- XVIII. Washington
- XIX. Francisco



I. Athen

(1) Parthenon (Ionic order)

柱: fluting: 20
sharp edge 3/8"
Entabl. 1/4" dx 1/4"
1/16" top + incline

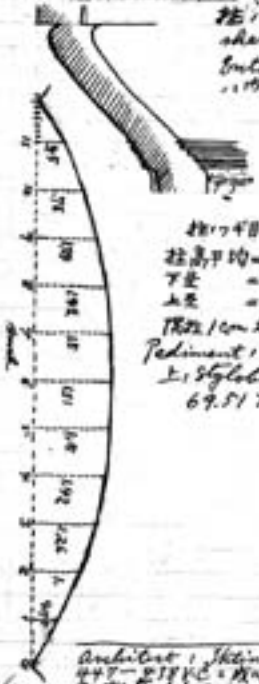

柱: 748, 1000 5.5' x 3.5'
柱高平均 = 10.43 m.
下段 = 1.905 m.
上段 = 1.981 m.
1822 1cm 2 = 10m 80 ?
Pediment: 102 = 13 1/2 度
上: Stylobat: 29
69.51 x 30.86 m.

Architect: Iktinos + Kallikrates
447 - 438 BC
E: 84 1/2 m x 31 m



新日東將
紅雲西去
波國再會

Propylaeon
 Ionic of the 4th order, 200.
 Ionic column = 2 ft. fluting 1/2 ft
 1/2 ft 1/2 ft

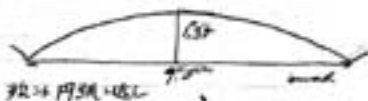

22 1/2 ft 1/2 ft 1/2 ft
 Ionic: 22: fluting: from Paestum

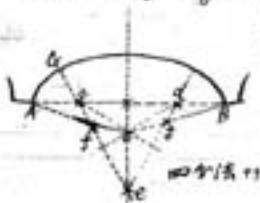

the diameter
 of the circle
 is 11 ft
 c d e de = 11

Nicae Temple
 Ionic order 25 ft 1/2 ft 1/2 ft

Section

3. Odeon

6. Theater of Bacchus.

4. Museion (Acropolis)



Intercolumnation = 1:2
 Capital for close column

7. Monument of Zeyreates,

比例 proportion 是 1:1 用 1: column 是 1:1
 freestanding, 1:1 的 柱 徑 的 高 度 是 1:1
 1:1 的 柱 徑 的 高 度 是 1:1
 Capital
 proportion 是 1:1 其 他 是 1:1



Fluting 止 端
 有 1:1 的 高 度
 是 1:1

上部 Capital 1:1 的 panel
 每 个 是 1:1 的 panel



Olympion: 柱 是 1:1 的 高 度 是 1:1
 柱 径 是 1:1 的 高 度 是 1:1
 上 1:1 的 高 度 是 1:1

7. Gate of Hadrian

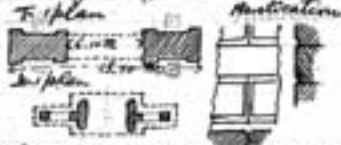

Cosmopolitan 1:1 的 高 度 是 1:1
 1:1 的 高 度 是 1:1
 下 1:1 的 arch

8. Olympion (Temp. des Olymp. Rome)
 Hadrian (117-138) 的 柱 是 1:1 的 高 度 是 1:1
 柱 径 是 1:1 的 高 度 是 1:1
 柱 径 是 1:1 的 高 度 是 1:1

Cosmopolitan 1:1 的 高 度 是 1:1
 1:1 的 高 度 是 1:1



是 1:1 的 高 度 是 1:1
 Capital 1:1 的 高 度 是 1:1
 柱 径 是 1:1 的 高 度 是 1:1
 柱 径 是 1:1 的 高 度 是 1:1



10. Stadion

(der Schauplatz der panathenäische Spiele)

im 550 v. C. Lykurgos, 1100 m. lang
 204 m. (für 6000 Personen)
 Olympia, 1920, Epidauros
 181 m. lang, 33.50 m. breit

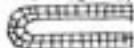

長 27.50 m. 47 階段
 大座席 247 階段
 五千人以上が座るべし

10.

11. Petite Métropole
 (Proximitie chapel)

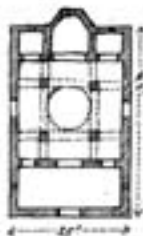

N.
... ..
... ..
... ..
... ..

...

No.

'Soviet Prison' + 塔
 和 Tomb + Triloma-hame. 07

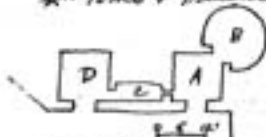

A 壁の天井
 2. 壁に light の取手あり。指内窓
 C. 完成
 D. flat ceiling. 中央に灯の置台あり
 壁は木造。床は石。壁の wall に 窓あり
 2 窓 反対に 置し あり

Prise.

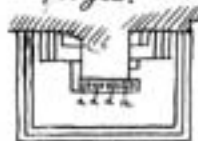

壁は木造の面あり
 壁の間に 窓あり
 2 窓

Syphlon.
 今 壁 壁 あり あり

Handwritten notes at the top of the right page.

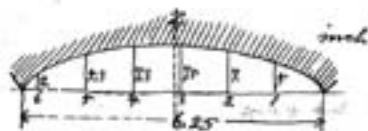

fluting あり あり
 柱の 上 あり drum の あり 下 あり
 上 あり

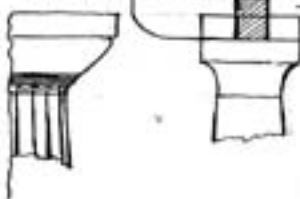

Russian Church.
 Byzantine. 聖堂 あり あり. 高 あり Bell
 fig 77 - 10 あり あり あり

Reference Books:

1. Die archaische Perse-Architektur der Hierapolis bei Athen von Theodor Wiegand. 1904.
 2. The principles of the Athenian Architecture by Francis Cranmer Penrose, Architect, M.A. F.R.A.S. London, Macmillan & Co. New York. 1888.
 3. 'Reisen in Lykien & Karien' von Otto Brendel & Georg Niemann. Wien 1889 2 Vol.
- Das Monument von Akropolis
 Professor Trautner von G. J. Hellens
 Wien 1895.
 (Kammitz: Journ. d'Arch. & d'Épigr. 1895, p. 110-112.)
4. Optische Täuschungen auf dem Gebiete der Architektur, von L. Hirsch. Berlin 1873.
 5. Das Karoon von Gjellarschi-Tyger von Otto Brendel & Georg Niemann Wien 1899
 (Abdruck aus dem Jahrbuch der Kunsthistorischen Commission der kaiserlichen Akademie der Wissenschaften)
 Vienna .. 4-1887. Wien. 1899. 12-1899.
 175. 7411. 1899. 1899. 1899. 1899. 1899. 1899.
 Capital 1899. 1899. 1899. 1899. 1899. 1899.
 1899. 1899. 1899. 1899. 1899. 1899.
 1899. 1899. 1899. 1899. 1899. 1899.

Syphilon Cemetery.

Philopappos.

214 Greek Architecture 214

1. diminution
2. Inclination inwards of axis of column.
3. Inclination outwards of the entablature.

Antae: 4 or 12 columns
Propylaea, 12 columns

Lechthei convex = Ran 1815

1. Cone: frustum + 2

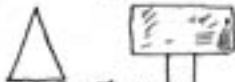

2. 重疊 + 4
3. straight sided arch (Chies. securo; inequalities 2)

Moulding: 10 or 12 conic sections: curve
+ 2 circles = monotone = 17
free hand curve = mathematical
curve = 9 or 10 or 11.

Horizontal line 1858

1858 - Vitruvius, 1858, 1858, 1858, 1858
1858 - Vitruvius, 1858, 1858, 1858, 1858
1858 - Vitruvius, 1858, 1858, 1858, 1858

1858 - Vitruvius, 1858, 1858, 1858, 1858
1858 - Vitruvius, 1858, 1858, 1858, 1858
1858 - Vitruvius, 1858, 1858, 1858, 1858

1858 - Vitruvius, 1858, 1858, 1858, 1858
1858 - Vitruvius, 1858, 1858, 1858, 1858
1858 - Vitruvius, 1858, 1858, 1858, 1858

1858 - Vitruvius, 1858, 1858, 1858, 1858
1858 - Vitruvius, 1858, 1858, 1858, 1858
1858 - Vitruvius, 1858, 1858, 1858, 1858

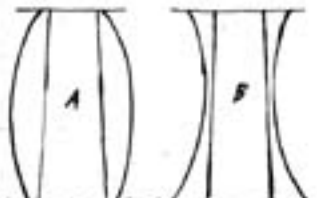

A B 或 1858 1858 1858 1858
A B 或 1858 1858 1858 1858

高地, 丘陵

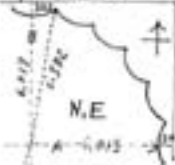

SE: {A=6.019
B=6.023

NW: {A=6.022
B=6.012

S. 4 {A= 1
B= 6.012
W 112 S. 87 E (with
flute)

Butaris (S. 4 = 11.2 N.W.)

	offset	
H		
31.25	31.25	31.25
30.75	30.75	30.75
30.25	29.95	31.60
29.75	29.75	29.75
29.25	29.25	29.25
28.75	28.75	28.75
28.25	28.25	28.25
27.75	27.75	27.75
27.25	27.25	27.25
26.75	26.75	26.75
26.25	26.25	26.25
25.75	25.75	25.75
25.25	25.25	25.25
24.75	24.75	24.75
24.25	24.25	24.25
23.75	23.75	23.75
23.25	23.25	23.25
22.75	22.75	22.75
22.25	22.25	22.25
21.75	21.75	21.75
21.25	21.25	21.25
20.75	20.75	20.75
20.25	20.25	20.25
19.75	19.75	19.75
19.25	19.25	19.25
18.75	18.75	18.75
18.25	18.25	18.25
17.75	17.75	17.75
17.25	17.25	17.25
16.75	16.75	16.75
16.25	16.25	16.25
15.75	15.75	15.75
15.25	15.25	15.25
14.75	14.75	14.75
14.25	14.25	14.25
13.75	13.75	13.75
13.25	13.25	13.25
12.75	12.75	12.75
12.25	12.25	12.25
11.75	11.75	11.75
11.25	11.25	11.25
10.75	10.75	10.75
10.25	10.25	10.25
9.75	9.75	9.75
9.25	9.25	9.25
8.75	8.75	8.75
8.25	8.25	8.25
7.75	7.75	7.75
7.25	7.25	7.25
6.75	6.75	6.75
6.25	6.25	6.25
5.75	5.75	5.75
5.25	5.25	5.25
4.75	4.75	4.75
4.25	4.25	4.25
3.75	3.75	3.75
3.25	3.25	3.25
2.75	2.75	2.75
2.25	2.25	2.25
1.75	1.75	1.75
1.25	1.25	1.25
0.75	0.75	0.75
0.25	0.25	0.25
0	0	0

Pantheon - B.B.B.



Temple Olympian at Paestum
The Columns



Lower diameter = 6.310

Upper diameter = 5.376

柱下之五等分一分为五上下之比例
 柱下之五等分一分为五上下之比例
 柱下之五等分一分为五上下之比例
 柱下之五等分一分为五上下之比例

Prothemon

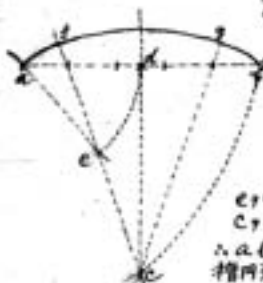

fluting

五

分

底

abac

adae

e + a + b + c

c + a + b + c

a, b, c, d, e, f, g, h, i, j, k, l, m, n, o, p, q, r, s, t, u, v, w, x, y, z

柱下之五等分

柱下之五等分

Jonic fluting, 1/2 Center, 1/2

+ 4/5 fluting.

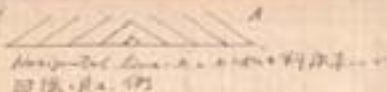

Horizontal line with a series of small triangles above it, representing a roof profile or decorative element.

四角・見上 例

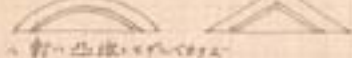

新しい凸線・例

例

例



例

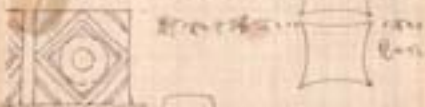

例



例

例

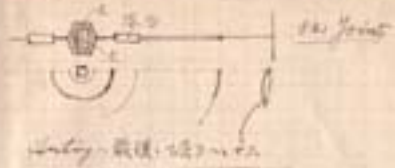

例

Summary of Horizontal Lines

Building	Height	Material	Cost
1. Jupiter Temple	Blank 2000	250000	100
2. Infirmary	Front 1000	100	100
	Blank 200	200	100
3. Theatrum	Front 450	100	100
	Blank 1000	100	100
4. Praelatum	Front 1000	100000	100000
	Blank 200	100	100000
	Installation for	100000	100
	Custom parts 1000	100000	100
5. Propaganda	Installation for	1000	100
	Custom parts 1000	100	100

Palladio, Scamozzi - F. 207 1/2, 14-174
 207 F. 207 1/2 大 174

又 Palladio - Pilaster 22 Schwelung
 25-27

卷 22 柱 1. Verzierung + 22 1712, 2. 27
 1712 22 Schwelung + 22 1712 22 22

Entasis 卷 22 柱 1712 22 22 1712
 柱 1712 22 22 1712 22 22

大 柱 1712 22 22 1712 22 22
 柱 1712 22 22 1712 22 22

柱 1712 22 22 1712 22 22
 柱 1712 22 22 1712 22 22

Röm. Relief, F. 184 1/2 173
 大 173 1/2 173 1/2 173 1/2 173 1/2

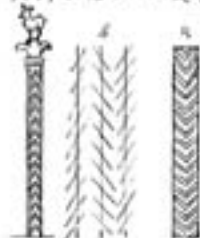

1. 173 1/2 173 1/2 173 1/2
 2. 173 1/2 173 1/2 173 1/2
 3. 173 1/2 173 1/2 173 1/2

Atyria Capital + base.



Measurement of Entasis

	Ratio of Dia. to Dia. at Top	Ratio of Dia. at Base to Dia. at Top	Ratio of Dia. at Base to Dia. at Top
Corinthian	6.40	0.0077	1/2
Thasian Capital	5.21	0.0070	1/2
Parthenon	9.58	0.0177	1/8
Propylaea A.C.	5.33	0.0117	1/2
Jupiter Olymp.	8.66	0.0171	1/2
	12.32	0.0360	1/3

Entasis Hyperbole + oval + 33
 173 1/2 (Pallas 173) + 27.

Renaissance F. 7 - Entasis

Architect's Screw Vignole's Conoid.

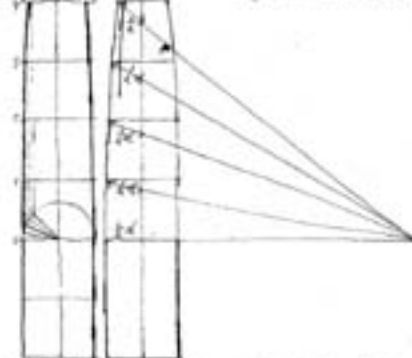

Entasis + Anamorphosis + F. 27 1/2 - 173
 173

Referenz Book No.
 Die phrygischen Fellenendenkmalen,
 Untersuchungen über Stil & Ausstattung
 seit von Franz von Kuhn.
 (Aus den Abhandlungen der K. Bayer.
 Akademie der Wiss. II. Cl. III. Bd. II. Abt.)
 München 1897
 Verlag der K. Akademie
 in Commission des J. Neumannschen Verlags.

足長と身長との関係
 足長は、身長に比例して変化する
 身長が、足長に比例して変化する
 身長と足長の比は、一定である
 身長と足長の比は、約 1.75 である



身長と足長の関係
 身長は、足長に比例して変化する
 足長は、身長に比例して変化する
 身長と足長の比は、一定である
 身長と足長の比は、約 1.75 である

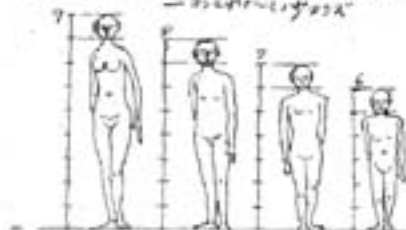



Agona - K - 18
L.

Agona - K - 18
L.
Agona - K - 18
L.
Agona - K - 18
L.

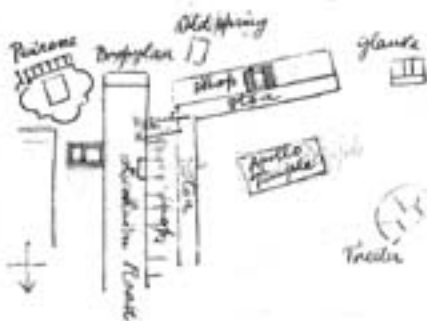

Agona - K - 18
L.
Agona - K - 18
L.
Agona - K - 18
L.
Agona - K - 18
L.

alt Corinth

Temple of
Hellas

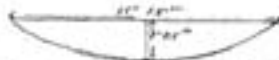
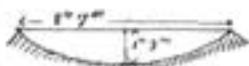

Basic step
to 1/2 of cent.
3.0 - 7.2
width 2.0

110, 11.15, 11.1

110, 11.15, 11.1

at Fida 1.72 m
= 1.50 m
L = 7.21 m.

at Fida 1.72 m
= 1.50 m
L = 7.21 m.

at Fida 1.72 m
= 1.50 m
L = 7.21 m.

alt Corinth
at Fida 1.72 m
= 1.50 m
L = 7.21 m.

Lion Gate at
Milane





人服華ノ古



児小ノ家農



高十平

同内並見25加。
コノ内119... 不境3境ノ上・平外不
7段ニヤレ。コ。

同内... 三ノ町・深ノ丸ノ7段ノ入ノカ
小費也
同・入ル... 獅子ノ7カアリ



人服華ノ今

Aedon (Hera's temple)

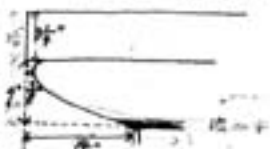

上座或... 下座或...

(1) 建築的 Ionic 柱在 (1) ...

1. Entasis 未完全... 柱身直線...

2. 柱身之 fluting - 在 (1) ...
the masonry (建築木匠之設計及...)

3. 柱身之木造部分... 柱身之...
柱身之...

4. 石料之質... Marble... 柱身...

5. Cell / 壁下之... 石之...
柱身之...

(的... Ionic Capital 柱身...
柱身之...)

6 fluting - 柱身之...
柱身之...

柱身之... 柱身之...
柱身之...

Loos Principle



此上の石面は厚く、その下に、
 1/2の厚さの石面あり。
 N: 104/10 fluting 104/10 104/10
 104/10 104/10 104/10 104/10
 104/10 104/10 104/10 104/10
 104/10 104/10 104/10 104/10

Metroon

1. 建築の primitive design 104/10 104/10
 104/10 104/10 Capital 104/10

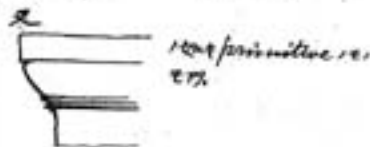

104/10 104/10 104/10 104/10



Philippine



A. 10. 11. 12. 13.

Corinthian Order: 10. 11. 12. 13.

1. Polyglotism
2. Palaeostion
3. Byzantine church (Lombard)
4. 10. 11. 12. 13.

Some Order: 10. 11. 12. 13.

1. Polyglotism
2. Baha Hall
3. Palaeostion 10. 11.
4. Side Terrace: 10. 11.
5. Lombardism
6. Byzantine church: 10. 11.
7. Palaeostion (Doric + 10.)

10. 11. 12. 13. Doric order: 10. 11. 12. 13.

Test Thor 10. 11. 12. 13. Doric: 10. 11. 12. 13.
2. 10. 11. 12. 13. fluting: 10. 11.



the Doric: fluting: 10. 11. 12. 13.



10. 11. 12. 13. 14. 15.

Capital: 10. 11. 12. 13.



等: 10. 11. 12. 13.



A. 10. 11. 12. 13. 14. 15. 16. 17. 18. 19. 20.

V. Pompeii

Handwritten notes, mostly illegible.

Handwritten notes, mostly illegible.



Construction - stone & brick w/ plaster
 3 层. 柱. 拱. 门. 窗. 装饰. 雕刻. 壁画
 装饰. 雕刻. 壁画. 装饰.

0. 1. 2. Windows, 拱. 门. 窗. 装饰. 雕刻. 壁画

0 House of Siriani:

Triclinium (dining room) 拱. 门.
 wall painting 拱. 门. 窗. 装饰. 雕刻. 壁画
 beds, panel, frieze, upper panel
 2 层.

Panel. 拱. 门. 窗. 装饰. 雕刻. 壁画
 3. 拱. 门. 窗. 装饰. 雕刻. 壁画

beds	panel
拱. 门. 窗. 装饰. 雕刻. 壁画	拱. 门. 窗. 装饰. 雕刻. 壁画
拱. 门. 窗. 装饰. 雕刻. 壁画	拱. 门. 窗. 装饰. 雕刻. 壁画
拱. 门. 窗. 装饰. 雕刻. 壁画	拱. 门. 窗. 装饰. 雕刻. 壁画
拱. 门. 窗. 装饰. 雕刻. 壁画	拱. 门. 窗. 装饰. 雕刻. 壁画

0. 2. 拱. 门. 窗. 装饰. 雕刻. 壁画

0. 3. 拱. 门. 窗. 装饰. 雕刻. 壁画

0 House of Jone (拱. 门. 窗. 装饰. 雕刻. 壁画)

Mosaic 拱. 门. 窗. 装饰. 雕刻. 壁画

1. Floor 拱. 门. 窗. 装饰. 雕刻. 壁画

0 A. of Caesia

walls 拱. 门. 窗. 装饰. 雕刻. 壁画

0 Eocene Mosaic

拱. 门. 窗. 装饰. 雕刻. 壁画

0 wall of Silyphus 拱. 门. 窗. 装饰. 雕刻. 壁画
 拱. 门. 窗. 装饰. 雕刻. 壁画



0 Triangular mosaic

Basic style 拱. 门. 窗. 装饰. 雕刻. 壁画

拱. 门. 窗. 装饰. 雕刻. 壁画

Colonnade 拱. 门. 窗. 装饰. 雕刻. 壁画

拱. 门. 窗. 装饰. 雕刻. 壁画

0 Stone Stabiana = Bath

wall painting 拱. 门. 窗. 装饰. 雕刻. 壁画

double wall, double floor, bath

拱. 门. 窗. 装饰. 雕刻. 壁画

floor in mosaic 拱. 门. 窗. 装饰. 雕刻. 壁画

light 拱. 门. 窗. 装饰. 雕刻. 壁画

Panel 拱. 门. 窗. 装饰. 雕刻. 壁画

Frieze 拱. 门. 窗. 装饰. 雕刻. 壁画

拱. 门. 窗. 装饰. 雕刻. 壁画

Restroom 拱. 门. 窗. 装饰. 雕刻. 壁画

0 House of Olympe

拱. 门. 窗. 装饰. 雕刻. 壁画

拱. 门. 窗. 装饰. 雕刻. 壁画

拱. 门. 窗. 装饰. 雕刻. 壁画

II. Napoli
MUSEUM NATIONAL

Sculpture. 在5000多件雕塑中，以希腊和罗马的雕像最为著名。其中有许多是古希腊和罗马的杰作。



衣服のデザインは、その時代の文化を反映している。彫刻の技術は、ギリシアとローマの彫刻家によって発展した。彫刻は、神像、人物像、動物像など、さまざまな主題を扱った。彫刻は、その時代の文化を反映している。彫刻は、その時代の文化を反映している。彫刻は、その時代の文化を反映している。

Pompeian Architecture

Mosaic: 各種色の鮮やかな、五層構造のモザイク。効果は、その時代の文化を反映している。彫刻は、その時代の文化を反映している。彫刻は、その時代の文化を反映している。彫刻は、その時代の文化を反映している。

- 0 House of Pallas
 Drawing room etc.
 Sado B. panel to heating system etc.
 21 panel, mosaic, etc. etc.
 21. Corinthian 218403.
- 0 House of
 21. Corinthian order, courtyard
- 0 Stomping Posture
 21. Corinthian order
- 0 Forum
- Temp. of Jupiter, Corinthian.
- 0 Bagiana, Corinthian & Ionic 21. 21.
 21. 21. 21. 21. 21. 21. 21. 21. 21. 21.
- 0 Temp. of Apollo, Corinthian & Ionic
 21. 21.
- 0 Museum
 人畜の天竺馬、金品などの彫刻、造像也
 21. 21.
 人馬の彫刻、頭部など、半彫刻
 左の彫刻の現

Curved Roof 阿... 阿... 阿...
阿... 阿... 阿...



Arch 阿... 阿... 阿...
阿... 阿... 阿...



阿... 阿... 阿... 阿...
horizontal + vertical line 阿...
Arch 阿... 阿... 阿... 阿...
阿... 阿... 阿... 阿...
阿... 阿... 阿... 阿... gable roof



阿... 阿... 阿...
阿... 阿... 阿...
阿...



Square plan 阿...
Pyramidal roof 阿... 阿...
阿... 阿...

阿... 阿... 阿... 阿...
阿... 阿... 阿... 阿...
阿... 阿... 阿... 阿...
阿... 阿... 阿... 阿...
阿... 阿... 阿... 阿...



2. 屋顶曲线
 Roof / 曲线
 曲线曲线
 曲线
 曲线
 曲线
 曲线
 曲线
 曲线

又...
 F. 曲线
 position
 曲线



1. 古典建筑
 古典建筑
 古典建筑
 古典建筑
 古典建筑
 古典建筑
 古典建筑
 古典建筑



1. 古典建筑
 古典建筑
 古典建筑
 古典建筑
 古典建筑
 古典建筑
 古典建筑
 古典建筑

gable roof: 3702 3712
Tomb 72



Round roof & 70222.
Conical roof - 70222
70222.

20 - Corinthisian
Example 77.



改屋 / 本型下は 2x2 panafit / 1212
Mant 77



gable + flat roof 70222 2x2 77
70222.

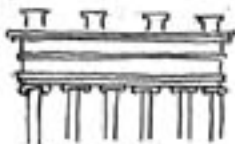

輕快 + 華やかな下 70222. Con-
Cave roof - 70222
70222.



Siracus



Aquila



Trani



Sculpture 大. 北. 2 號. - f. 100 - art
Christian Era. 200 年代. 聖. 2 號.
中心. 再. 2 號. 100 年代. 2 號.
2. 2 號. 100 年代. 2 號.

3. St. Oliveto. (14th C.)
Renaissance, 14th C. Sculpture
2. 2 號. 100 年代.
Architecturally. 14th C.

53

Balnetta



Bari



下部+高+外架+内. 200 年代. 2 號.
二. 4 號. 中央. 柱.
200 年代. 2 號.
2. 2 號. 100 年代. 2 號.



2. San Martino
Renaissance, 14th C. Sculpture
2. 2 號. 100 年代.

*Architectural Examples in
Italian.*

- I** *Grecian Arch.*
 Paestum. (7th Cent. B.C.)
- II** *Roman Arch.*
 Pantheon at Rome. (A.D. 125)
 Diocletian's Temp. at Spalato (A.D. 304)
 Trajan's Basilica at Rome (A.D. 98)
 Basilica of Maxentius (or Temple
 of Peace) at Rome (A.D. 312)
 Baths of Caracalla at Rome
 Flavian Amphitheater (Colosseum)
 Amphitheater at Verona (A.D. 70)
 Arch of Titus at Rome (A.D. 81)
 Tomb of Cecilia Metella at Rome
 Palace of Constantine on the Palatine
 Hill, Rome
 Palace of Diocletian at Spalato
 in Dalmatia. (5th C.)
 Houses in Pompeii.
- III** *Early Christian Style.*
 Baptistery of Constantinian, Rome
 St. Stefano Rotondo (6th Cent.)
 Baptistery at Novara.
 Old Basilica of St. Petrus.
- IV** *Byzantine Style.*
 St. Vitale at Ravenna (526)
 Tomb of Galla Placidia, Ravenna
 Tomb of Theodoriz at Ravenna (530)
 St. Mark's, Venice (1063-1071)

*St. Santa Chiara
 (1310, Robert de' Salluzie, 1546)*

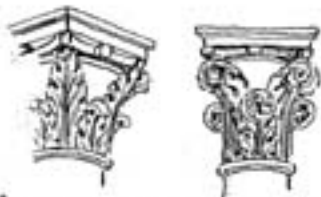

Acanthus 2 1/2 1/2 1/2 1/2 1/2 1/2 1/2 1/2



Cathedral at Messina
" at Mendicane
" " Palermo

III. Renaissance style.

A. Florentine school.

Riccardi Palace (1470)
Pitti Palace (1470)
Strozzi Palace (1489)

B. Roman school

✓ Cancelleria Palace (1508)
✓ Giraud Palace (1508)
✓ Belvedere Court of the Vatican (1511)
✓ The small temple in the cloister
of St. Peter in Montorio (1517)

Cathedral at Bassano Romano (1498-1536)

✓ Villa Farnese 1546
Bramante (1500-1570)
V.S. 1507-1570

✓ Ant. di Sangallo (1478-1546)
Farnese Palace 1546
Raphael (1483-1520)

✓ Giulio Romano (1492-1546)
✓ Vignola (1530-1599)
✓ Michelangelo (1475-1564)
St. Peter 1564

V. Romanesque style.

Cathedral of Pisa (1063-1092)
St. Michael, Lucca (1188)
Lucca Cathedral (1288)
Cathedral at Pistoia (12^d C.)
Cloister of St. John Lateran (12^d C.)
St. Minerva, Florence Rome

Church of Anton's, Paduana (12^d C.)
" of St. Michael, Parma (1196)
" St. Ambrogio, Milan (12^d C.)
" St. Zenone, Verona (1159)
1159

Palazzo Farnese & Ludovico
(Fondaco dei Turchi) Venice
Church at Montreale (1194) Palermo
(Byzantine & Norman influence)
Capella Palatina, Palermo
S. Nicola Bari (1177)

VI. Gothic style.

Milan Cathedral (1385-1418)
Hospital at Milan
Cortona at Pavia (1396)
Churches & Palaces at Bologna,
Vicenza, Padua, Verona, Cremona,
Genoa.

✓ Pope's palace (1420-1440) Venice
✓ La Dora Palace, Venice
Cathedral of Florence (1294-1468)
Cathedral of Siena (1272)
Crosico Cathedral (1290)
St. Francis at Assisi (1188-1228)

Campanille

Masse inclined outline of 200
第1段の長さ 7.10 11, arch 20 22 25
中. Tuscan pedestal, 2, 2, 2, 2
三角の上. Ionic pedestal 2 2 2 2
12. segmental pediment 7 18
二層二層 五以上 20 40 10 10
= 橋 = fence = Melopu + height = 10.

中運系. 7. 橋 = Corbeling of abacus, style.
五 = 一段の長さ 12. 12. Front

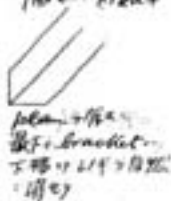

F. Romanica Maggiore



plan.

schönok style 1
1870 - 1875

3. 1184-1194 in Mohamada Motive



(1289 Karl I. 1212.
1350-55. 1289?)

6. Suomo

(1294-1329)



Portal - 1407. 1212.
1289 1212. 1212.
1289 1212.
French Gothic
Influence 1212.

7. St. Giobanni a Carbonara

(1344)

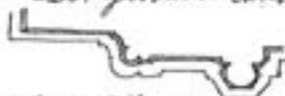

St. Giobanni a Carbonara
1344. 1344. 1344.

Rome

Capitoline Museums, Rome
Roman vs Gothic - 2 stages
R. 2.

3. Castel Capuano

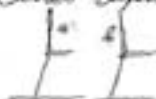

Wall 14' x 11'
14' x 11' x 11'
14' x 11' x 11'
14' x 11' x 11'
14'

99. Palazzo Cuomo.
Early Renaissance style - 1578
restoration held in effect
R. 2.

100. Porta Capuana (1485-1497)
1497-1497)

11. St. Lorenzo (1266-1320) - R.
Bell-tower - 1487-1497.

12. Triumphal arch of Castel Nuovo
1493-1497 on 14
R. 2. Bell tower design - purity &
simplicity 2 + 2 Bell tower
classic style - 27-28-29.

5. *Pantheon*
 Augustus to Nerva, 1st c. AD
 Christian church + +
 Top light, effect of light
 Vault, panel etc. (see notes)
 Curvature etc.
 detail (see notes) (see notes)
 see notes, 1, 2, 3, 4, 5, 6, 7, 8, 9, 10, 11, 12, 13, 14, 15, 16, 17, 18, 19, 20, 21, 22, 23, 24, 25, 26, 27, 28, 29, 30, 31, 32, 33, 34, 35, 36, 37, 38, 39, 40, 41, 42, 43, 44, 45, 46, 47, 48, 49, 50, 51, 52, 53, 54, 55, 56, 57, 58, 59, 60, 61, 62, 63, 64, 65, 66, 67, 68, 69, 70, 71, 72, 73, 74, 75, 76, 77, 78, 79, 80, 81, 82, 83, 84, 85, 86, 87, 88, 89, 90, 91, 92, 93, 94, 95, 96, 97, 98, 99, 100, 101, 102, 103, 104, 105, 106, 107, 108, 109, 110, 111, 112, 113, 114, 115, 116, 117, 118, 119, 120, 121, 122, 123, 124, 125, 126, 127, 128, 129, 130, 131, 132, 133, 134, 135, 136, 137, 138, 139, 140, 141, 142, 143, 144, 145, 146, 147, 148, 149, 150, 151, 152, 153, 154, 155, 156, 157, 158, 159, 160, 161, 162, 163, 164, 165, 166, 167, 168, 169, 170, 171, 172, 173, 174, 175, 176, 177, 178, 179, 180, 181, 182, 183, 184, 185, 186, 187, 188, 189, 190, 191, 192, 193, 194, 195, 196, 197, 198, 199, 200, 201, 202, 203, 204, 205, 206, 207, 208, 209, 210, 211, 212, 213, 214, 215, 216, 217, 218, 219, 220, 221, 222, 223, 224, 225, 226, 227, 228, 229, 230, 231, 232, 233, 234, 235, 236, 237, 238, 239, 240, 241, 242, 243, 244, 245, 246, 247, 248, 249, 250, 251, 252, 253, 254, 255, 256, 257, 258, 259, 260, 261, 262, 263, 264, 265, 266, 267, 268, 269, 270, 271, 272, 273, 274, 275, 276, 277, 278, 279, 280, 281, 282, 283, 284, 285, 286, 287, 288, 289, 290, 291, 292, 293, 294, 295, 296, 297, 298, 299, 300, 301, 302, 303, 304, 305, 306, 307, 308, 309, 310, 311, 312, 313, 314, 315, 316, 317, 318, 319, 320, 321, 322, 323, 324, 325, 326, 327, 328, 329, 330, 331, 332, 333, 334, 335, 336, 337, 338, 339, 340, 341, 342, 343, 344, 345, 346, 347, 348, 349, 350, 351, 352, 353, 354, 355, 356, 357, 358, 359, 360, 361, 362, 363, 364, 365, 366, 367, 368, 369, 370, 371, 372, 373, 374, 375, 376, 377, 378, 379, 380, 381, 382, 383, 384, 385, 386, 387, 388, 389, 390, 391, 392, 393, 394, 395, 396, 397, 398, 399, 400, 401, 402, 403, 404, 405, 406, 407, 408, 409, 410, 411, 412, 413, 414, 415, 416, 417, 418, 419, 420, 421, 422, 423, 424, 425, 426, 427, 428, 429, 430, 431, 432, 433, 434, 435, 436, 437, 438, 439, 440, 441, 442, 443, 444, 445, 446, 447, 448, 449, 450, 451, 452, 453, 454, 455, 456, 457, 458, 459, 460, 461, 462, 463, 464, 465, 466, 467, 468, 469, 470, 471, 472, 473, 474, 475, 476, 477, 478, 479, 480, 481, 482, 483, 484, 485, 486, 487, 488, 489, 490, 491, 492, 493, 494, 495, 496, 497, 498, 499, 500, 501, 502, 503, 504, 505, 506, 507, 508, 509, 510, 511, 512, 513, 514, 515, 516, 517, 518, 519, 520, 521, 522, 523, 524, 525, 526, 527, 528, 529, 530, 531, 532, 533, 534, 535, 536, 537, 538, 539, 540, 541, 542, 543, 544, 545, 546, 547, 548, 549, 550, 551, 552, 553, 554, 555, 556, 557, 558, 559, 560, 561, 562, 563, 564, 565, 566, 567, 568, 569, 570, 571, 572, 573, 574, 575, 576, 577, 578, 579, 580, 581, 582, 583, 584, 585, 586, 587, 588, 589, 590, 591, 592, 593, 594, 595, 596, 597, 598, 599, 600, 601, 602, 603, 604, 605, 606, 607, 608, 609, 610, 611, 612, 613, 614, 615, 616, 617, 618, 619, 620, 621, 622, 623, 624, 625, 626, 627, 628, 629, 630, 631, 632, 633, 634, 635, 636, 637, 638, 639, 640, 641, 642, 643, 644, 645, 646, 647, 648, 649, 650, 651, 652, 653, 654, 655, 656, 657, 658, 659, 660, 661, 662, 663, 664, 665, 666, 667, 668, 669, 670, 671, 672, 673, 674, 675, 676, 677, 678, 679, 680, 681, 682, 683, 684, 685, 686, 687, 688, 689, 690, 691, 692, 693, 694, 695, 696, 697, 698, 699, 700, 701, 702, 703, 704, 705, 706, 707, 708, 709, 710, 711, 712, 713, 714, 715, 716, 717, 718, 719, 720, 721, 722, 723, 724, 725, 726, 727, 728, 729, 730, 731, 732, 733, 734, 735, 736, 737, 738, 739, 740, 741, 742, 743, 744, 745, 746, 747, 748, 749, 750, 751, 752, 753, 754, 755, 756, 757, 758, 759, 760, 761, 762, 763, 764, 765, 766, 767, 768, 769, 770, 771, 772, 773, 774, 775, 776, 777, 778, 779, 780, 781, 782, 783, 784, 785, 786, 787, 788, 789, 790, 791, 792, 793, 794, 795, 796, 797, 798, 799, 800, 801, 802, 803, 804, 805, 806, 807, 808, 809, 810, 811, 812, 813, 814, 815, 816, 817, 818, 819, 820, 821, 822, 823, 824, 825, 826, 827, 828, 829, 830, 831, 832, 833, 834, 835, 836, 837, 838, 839, 840, 841, 842, 843, 844, 845, 846, 847, 848, 849, 850, 851, 852, 853, 854, 855, 856, 857, 858, 859, 860, 861, 862, 863, 864, 865, 866, 867, 868, 869, 870, 871, 872, 873, 874, 875, 876, 877, 878, 879, 880, 881, 882, 883, 884, 885, 886, 887, 888, 889, 890, 891, 892, 893, 894, 895, 896, 897, 898, 899, 900, 901, 902, 903, 904, 905, 906, 907, 908, 909, 910, 911, 912, 913, 914, 915, 916, 917, 918, 919, 920, 921, 922, 923, 924, 925, 926, 927, 928, 929, 930, 931, 932, 933, 934, 935, 936, 937, 938, 939, 940, 941, 942, 943, 944, 945, 946, 947, 948, 949, 950, 951, 952, 953, 954, 955, 956, 957, 958, 959, 960, 961, 962, 963, 964, 965, 966, 967, 968, 969, 970, 971, 972, 973, 974, 975, 976, 977, 978, 979, 980, 981, 982, 983, 984, 985, 986, 987, 988, 989, 990, 991, 992, 993, 994, 995, 996, 997, 998, 999, 1000

6. *Gesù*
 17-18 c.

7. *Mon. Carlo Alberto*
 19-20 c.

8. *Fontana di Trevi*
 17-18 c.

1. *Museo Borghese*
 Sculpture of Bernini's era
 17-18 c. / 17-18 c. / 17-18 c. / 17-18 c.

Napoleon I, Bataillon
 (1805) 17-18 c. / 17-18 c.
 17-18 c. / 17-18 c. / 17-18 c.

2. *S. M. Popolo*
 Sixtus II, 1st (1477-80) 17-18 c.
 Bernini's Baroque style
 17-18 c. / 17-18 c.
 Architecturally 17-18 c.

3. *Accademia di Francia*
 17-18 c. / Sculpture, gips -
 abgisse etc. / 17-18 c.
 17-18 c. / fragment etc.

4. *S. S. Trinita de Monti*
 17-18 c.

12. Forum Romanum

13. Forum Augusti

14. Basilica

15. Forum di Traiano

16. Colosseum

17. Fort. Aegypti Constantiniana

67

9. Gall. d'Arte Moderna
550 50 300 200 100 50
51 100 150 200

10. Museo Capitolini
1115 600 300 150 75
1115 600 300 150 75
1115 600 300 150 75

11. Gal. Concordia

21. Katakomben.

972-77. 池中 stone 遺し 91 階.
上. 大 4 尺 大 4 尺 大 4 尺 大 4 尺 大 4 尺
7 中 長 22. Marble slab
9 遺し 10 上 inscription 51
Sculpture 上 遺し 27

22. St. Sarcophagi with family

-- 遺し 27 上 遺し 27 上 遺し 27

22. Terme di Traiano + Tito

遺し 27 上 遺し 27

23. Bath of Caracalla

遺し 27 上 遺し 27 上 遺し 27
遺し 27 上 遺し 27 上 遺し 27
遺し 27 上 遺し 27 上 遺し 27

Capital, sculpture, fragment
mosaic, 971 上 77. masonry
wall. 10 brick. 10 上 77. Marble
10 77 10 77 10 77. Marble
caused 10. facing 10 77 marble
10 77 10 77.

18. S. M. de Sole (S. Stefano delle
Carrozze).

Round Temple + 7. 10 77. = 10 77
Corinthian Columns 遺し 27. 長 27 上 27
4 上 7 上 6 上 7 上.

19. Pyramide

110. 27 上 10 77. 遺し 27 上 77 上 77

遺し 27 上 77 上 77 上 77

遺し 27 上 77 上 77 上 77



20. S. Paolo (10 77. 10 77)

Basilica style 10 77. 10 77 上 77
10 77 上 77 上 77
10 77 上 77 上 77
4 77. 10 77. 10 77 上 77
10 77 上 77. 10 77 上 77 上 77
10 77 上 77 上 77 上 77 上 77

Accademia Franca

Gipscom. 1870. 1871. Sculptura
1872. 1873.



S. Pietro in Vincoli

1874. 1875. Michelangelo
1876. 1877. 1878. 1879.
1880. 1881.

Accademia Franca

1882. 1883. 1884. 1885. 1886.
1887. 1888. 1889. 1890. 1891.
1892. 1893. 1894. 1895. 1896.

Museo Nazionale

28. S. M. Maggiore (1478-)

Architecturally. 柱. 穹顶. 嵌石
 Marble 嵌. 石. floor. inlaid work
 嵌. 石. 嵌. 石. 嵌. 石. 嵌. 石. 嵌. 石
 嵌. 石. 嵌. 石. 嵌. 石. 嵌. 石. 嵌. 石

29. S. Giovanni in Fonte (Baptistery)

S. Giovanni in Laterano (1078-)
 212. Constantin 1078. 215. 216. 217. 218
 219. 220. Franc. Borromini (1650)
 221. facade. Aless. Galilei (1757).
 modernism 1854.
 decoration 1854. 1855. 1856. 1857. 1858.
 1859. 1860. 1861. 1862. 1863. 1864.
 sampling & ceiling. 1865. 1866. 1867.
 white marble. 1868. 1869. 1870.
 contrast 1871.
 floor. mosaic. 1872. 1873. 1874.
 1875. 1876. 1877. 1878. 1879. 1880.
 1881. 1882. 1883. 1884. 1885. 1886.
 1887. 1888. 1889. 1890. 1891. 1892.
 1893. 1894. 1895. 1896. 1897. 1898.
 1899. 1900. Ornament.
 1901. 1902. 1903. 1904.

Muller



Joune endormie



75

Venus accomplice



76

31 Raphael's Stanzas

a. 12. 14. 15. 16. 17.

(Stanza dell' Incendio)

b. Stanza della Segnatura

c. Stanza d'Elindore

d. Stanza d'Elindore

(S. di Costantino & S.)

M. Stanza d'Elindore

Stanza della Sistina (S.)

32 Peter's Gallery

Raphael: Madonna, Lictor,

Stanza d'Elindore

30. Peter's

Stanza d'Elindore

M. Stanza d'Elindore

Stanza d'Elindore

Stanza d'Elindore

Stanza d'Elindore

Stanza d'Elindore

Stanza d'Elindore

Stanza d'Elindore

Vatican

55. *Palazzo di Nicola V.*
on the Arch of Constantine wall painting
- 1/2 (1/2) -) with the Arch of Constantine
Lion of Saint Mark, Michelangelo's Pieta
Raphael. 1498-99. St. Peter's Chapel & St. Peter's.

56. *Palazzo Loggia*
Raphael. 1511-12. St. Peter's Chapel & St. Peter's.
St. Peter's Chapel & St. Peter's Chapel.
St. Peter's Chapel & St. Peter's Chapel.
St. Peter's Chapel & St. Peter's Chapel.

57. *Palazzo Giroud*
Roman school, Renaissance, 16th
century. Raphael. 1511-12. St. Peter's
Chapel & St. Peter's Chapel.

58. *Palazzo Cancellaria*
Roman school, Renaissance
style, 16th century.

59. *Palazzo Field Bernasconi*
Roman school, Renaissance,
16th century.

60. *Palazzo Farnese*
Roman school, Renaissance, 16th
century.

34. *Museum of Vatican*
Antiquary Museum.

6. *Egyptian Museum*
Egyptian Museum, 1858-60.
Egyptian Museum, 1858-60.

11. *Roman Museum*
Roman Museum, 1858-60.
Roman Museum, 1858-60.

4. *Raphael's Raphael*

E. *Bibliotheca*
Bibliotheca, 1858-60.
Bibliotheca, 1858-60.

St. Peter's Chapel & St. Peter's Chapel.
St. Peter's Chapel & St. Peter's Chapel.
St. Peter's Chapel & St. Peter's Chapel.

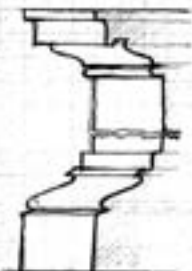

moulding E 3
H 2. B 3.

42 Museo St. Giovanni

Antique obelisk of granite 10' 6" high
Sarcophagus of marble 5' 6" x 3' 6" x 2' 6"
Sarcophagus, 3' 6" x 3' 6" x 2' 6"
10' 6" x 3' 6" x 2' 6"

43 Mt Palatino

Rome 500' B.C. 1' x 2' x 1' 6"
with arch of marble
facade 2' 6" x 1' 6" x 1' 6"
by 1' 6" x 1' 6" x 1' 6" (cont. of 1' 6" x 1' 6")
1' 6" x 1' 6" x 1' 6"

41 Monument of Garibaldi

1872
1872
1872



base 2' 6" x 2' 6" x 2' 6"
18' 6" x 25' 6" x 8' 2" x 8"
proportion 200 = 1800
detail etc



52. S. Maria in Cosmedin
創立 5世紀初。1874-77。改修。
Bell tower 12世紀。鐘樓。
年數 - 12-14。中古。建築史上。
重要之建築。

Bell tower. 12世紀。
1874-77。1875 - Byzantine
鐘樓。鐘樓。鐘樓。

53. Santa Ruffa
1874-77。1875。

59. S. M. Egiziaca
1874-77。1875。

2. Stroggi Palace

= Pl. fluctuation 2nd to 3rd floor
 = 1st floor: Corinthe projection 7 + 1 x 2
 Base 10' x 17' dignity + 2
 = 2nd floor window treatment 20' x 22'
 + 1' (10' 05")
 2nd floor Corinthe projection & treatment
 too much -> Fr. simple one match as
 Bar - 14' flat surface shadow
 + shade + 10' architecturally
 value 7 + 2.05

3. Duomo

Gothic style + 271 Euc Renaissance
 43' detail Gothic motives 788 + 2
 12. Gothic 1st floor 10' 1st floor
 14' 1st floor 10' 1st floor 10' 1st floor
 St. Peter 4th floor 12' horizontal line
 17 Gothic 20' 2nd floor 20' unfinished
 18' Proportion 20' 1st floor
 Campanile - Gothic + 20' Renaissance
 1 feature 77
 1st floor Baptistry 77 1st floor wall 4' 10'
 1st floor 1st floor Renaissance 1st floor
 1st floor mosaic painting 9' floor
 1st floor by 1st floor 1st floor
 1st floor 1st floor 1st floor 1st floor
 1st floor 1st floor 1st floor 1st floor
 1st floor 1st floor 1st floor 1st floor

Firenze

1. Palazzo Pitti & Galleria Palatina
2. Stroggi
3. Medici
4. Riccardi
5. Uffizi Museum
6. Bargello & National Museum
7. Palazzo Vecchio & Archaeological Museum
8. Duomo & Duomo Museum
9. S. Croce
10. S. Miniato
11. S. M. Nuovo
12. S. Lorenzo & new sacristy
13. Piazza Michelangelo
14. Palazzo Vecchio
15. Loggia dei Lanzi
16. S. Marco & Museum
17. Accademia delle Belle Arti
18. S. Annunziata
19. S. Spirito
20. Indian Museum
21. S. Maria del Carmine
22. S. Trinita

1. Pal. Luccalari

1st floor Renaissance 77 1st floor 1st floor
 wall 2' 4' 7' 1st floor 1st floor
 1st floor 1st floor 1st floor 1st floor
 1st floor 1st floor 1st floor 1st floor
 = 1st floor window 1st floor 1st floor
 77 77

[Faint, illegible handwritten notes]

9. *[Faint, illegible handwritten notes]*

- *[Faint, illegible handwritten note]*
- *[Faint, illegible handwritten note]*
- *[Faint, illegible handwritten note]*
- *[Faint, illegible handwritten note]*
- *[Faint, illegible handwritten note]*
- *[Faint, illegible handwritten note]*
- *[Faint, illegible handwritten note]*
- *[Faint, illegible handwritten note]*
- *[Faint, illegible handwritten note]*
- *[Faint, illegible handwritten note]*
- *[Faint, illegible handwritten note]*
- *[Faint, illegible handwritten note]*
- *[Faint, illegible handwritten note]*
- *[Faint, illegible handwritten note]*

[Faint, illegible handwritten notes]

[Faint, illegible handwritten notes]

[Faint, illegible handwritten section header]

[Faint, illegible handwritten section header]

[Faint, illegible handwritten notes]

11. d. Lalanga

（王宮建築）又ハ是故修テ後ハ今、巧ク又

Pinotocapelle

ハ聖堂ハ金石ノ鑿ドメニ由リテ又ハ今ハ

New Sacristy (Michelangelo)

Sculpture 700 諸君 700 800 諸君

（料）諸君 900 諸君 1000 諸君

（工）金器 1000 諸君 1100 諸君

（人物）諸君 1200 諸君 1300 諸君

（等）巴力士 1400 諸君 1500 諸君

（手）一語、Sculptor 又ハ 77 諸君 又ハ 3

12. d. Maria Novella

1275 創建 1350 修 1474 Fra Jac Tolent

1474 修

Hauptportal 1475-70 Gio. Bertini

外部 front elevation - Romanesque

（7）彫刻 1475 諸君 1475 諸君

（14）法ノ諸君 Oriental origin 1475 諸君

74 - Gothic 7 simple 1475 諸君

Fresco 75 Giotto school 1475 諸君

1475 諸君

（7）西ノ諸君 1475 諸君

（14）建築 1475 諸君 Front elevation

1475 諸君

Museo Nazionale (Pal. Bargello 177)

A 諸君

C. 諸君

C. 諸君 177 諸君 177 諸君

177 諸君 177 諸君

177 諸君 177 諸君

177 諸君 177 諸君

177 諸君 177 諸君

177 諸君 177 諸君

177 諸君 177 諸君

177 諸君 177 諸君

177 諸君 177 諸君

177 諸君 177 諸君

177 諸君 177 諸君

177 諸君 177 諸君

177 諸君 177 諸君

177 諸君 177 諸君

177 諸君 177 諸君

177 諸君 177 諸君

177 諸君 177 諸君

177 諸君 177 諸君

177 諸君 177 諸君

177 諸君 177 諸君

177 諸君 177 諸君

177 諸君 177 諸君

177 諸君 177 諸君

177 諸君 177 諸君



17 Monument of David

Michelangelo 1475-1564
 1565-1566 (1565-1566)
 1566-1567 (1566-1567)
 1567-1568 (1567-1568)
 1568-1569 (1568-1569)
 1569-1570 (1569-1570)



1565-1566 (1565-1566)
 1566-1567 (1566-1567)
 1567-1568 (1567-1568)
 1568-1569 (1568-1569)
 1569-1570 (1569-1570)

18 d. Coara

1565-1566 (1565-1566)
 1566-1567 (1566-1567)
 1567-1568 (1567-1568)
 1568-1569 (1568-1569)
 1569-1570 (1569-1570)

1565-1566 (1565-1566)
 1566-1567 (1566-1567)
 1567-1568 (1567-1568)
 1568-1569 (1568-1569)
 1569-1570 (1569-1570)

1565-1566 (1565-1566)
 1566-1567 (1566-1567)

1565-1566 (1565-1566)
 1566-1567 (1566-1567)

19 d. Monumento

1565-1566 (1565-1566)
 1566-1567 (1566-1567)
 1567-1568 (1567-1568)
 1568-1569 (1568-1569)
 1569-1570 (1569-1570)

16. Museo Archæologische

1. Præhistorische funde.
Gräber mit Bronze, Ton.
1000 v. Chr. bis 500 v. Chr.

2. Agyptische Museum
1000 v. Chr.



3. Griechische Museum
Tempel, Statuen, Vasen, Münzen, etc.
500 v. Chr. bis 300 v. Chr. Greek Period
700 v. Chr.

4. Griech. Klassik. Museum
Antike, etc.



Antike, etc.
Klassik, etc.
Antike, etc.

Antike, etc.
Klassik, etc.

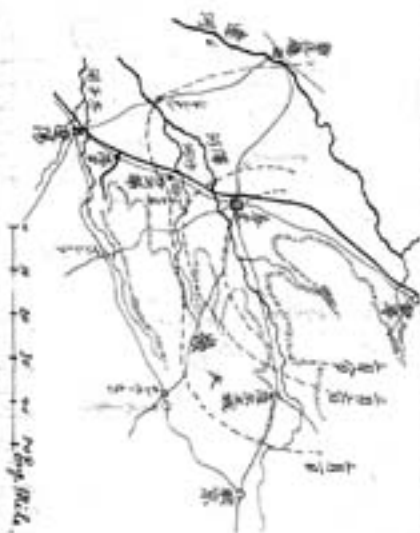

20. S. Trinita

17th Renaissance by the Florentine
 architect Niccolò Pisano
 facade 1480-1520
 facade 1480-1520
 facade 1480-1520
 facade 1480-1520
 facade 1480-1520
 facade 1480-1520

21. S. Maria Carmine

1782 by Ferdinando
 Capriani
 facade 1782
 facade 1782
 facade 1782
 facade 1782
 facade 1782

22. Ricciardi Palace

18th Century Neoclassical facade - flat
 - window in same treatment
 facade 18th Century
 facade 18th Century
 facade 18th Century
 facade 18th Century
 facade 18th Century

19. S. Spirito

17th Century Baroque
 facade 17th Century
 facade 17th Century
 facade 17th Century
 facade 17th Century
 facade 17th Century

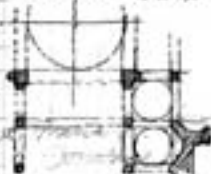

1936. Brunelleschi

design 1482
 facade 1482
 facade 1482
 facade 1482
 facade 1482
 facade 1482





Handwritten notes in Chinese characters, likely describing the structure above.

Additional handwritten notes in Chinese characters.



Handwritten notes below the four small drawings.

2. Palazzo Ducale

Main body of handwritten notes in Chinese characters, providing detailed information about the Palazzo Ducale.



Handwritten notes in Chinese characters next to the dome drawing.

Venete

1. San Marco
2. Palazzo ducale
3. Museo q' ducale
4. Frari
5. S. Giovanni e Paolo
6. Scuola di S. Rocco
7. S. Stefano
8. S. M. della Salute
9. S. Giorgio Maggiore
10. Palazzo Vendramini
11. Pesaro
12. Accademia della Bella Arti

1. San Marco

Main body of handwritten notes in Chinese characters, providing detailed information about San Marco.

5 Scuola di S. Rocco.

Best. Buon (1517), designed 1524-50
 17. Santa Lombardo + Scapagnino
 18. An. 1517 Renaissance, floor, 17.
 19. 1517 Venetian Renaissance, 17.
 20. 1517 French, 17.
 1849. Jac. Fonttelle (1550-79),
 wall painting (1527). 2. Fixian,
 1. 1517. Fonttelle. 17. 1527. Naturalistic. 17. 1517. 17. 1527. 17. 1527.
 17. 1517.

6. S. Stefano

17th cent. = Horn Gothic style 17.
 18. Fresco 17. 17. 17. 17.
 19. 17. 17. 17. 17. 17.
 20. 17. 17.

7. S. Roccacia

(1458-1515) Ant. Gambello + Mors
 Coducci 17. Gothic of Renaissance. 17. 17. 17. 17.
 17. 17. 17. 17. 17. 17.

3 Trarsi

17. 17. 17. 17. 17. 17.
 17. 17.
 detail:
 17. 17. 17.
 17. 17. 17.
 17. 17. 17.
 Fresco 17. 17. 17.

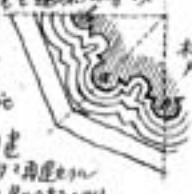

Windows frame:



17. 17. 17. 17. 17. 17.
 Gothic.
 17. 17. 17. 17. 17. 17.

8. Giovanni a Palio

(1337-70?) Italian Gothic 17. 17. 17.
 17. 17. 17. 17. 17. 17.
 17. 17. 17. 17. 17. 17.
 17. 17. 17. 17. 17. 17.
 Chapel 17. 17. 17.
 17. 17. 17.



8. Giovanni e Paolo
 Renaissance + Gothic 1475-1480
 Capital + Renaissance + Gothic
 1. Gothic + Renaissance + Gothic



Gothic Classic

9 Scuola di S. Marco
 Facade - very richly decorated
 Gothic + Renaissance + Gothic
 Arch: wall, perspective, relief
 Gothic + Renaissance + Gothic
 2. Gothic + Renaissance + Gothic



10. S. Maurizio
 Campanile - Gothic + Renaissance
 Pisa - Gothic + Renaissance foundation
 1792 - 1817

Venice... pile of light appearance
 1792 - 1817

8 Accademia della
 Bella Arti
 1713-1717
 Tizian - 1518-1591 Raffael 1483-1520

Paolo Veronese 1528-1588
 Bonifazio 1571-1608
 Jac. Tintoretto
 Marco Basaiti
 Rocco Marcioni
 Palma Vecchio
 Vittorio Carpaccio
 Gentile Bellini
 Giovanni Procaccino
 1478-1528
 1478-1528

S. Marco 1063-1071
 { Giovanni Mansueti
 { Ep. Fine Dec. XI - principio XII.
 { Episodii della vita di S. Marco
 { Giovanni Mansueti
 { Ep. Fine Dec. XI - principio XII.
 { S. Marco che Risana Aniam.
 veduta Arabia 1173-1182
 1173-1182

Verona

1. Palazzo Pompeio (Musco Civico)
2. Palazzo del Consiglio (Leggia)
1718 - Spicaffito + 2nd decoration
1769 - arabesque + curved pl.
interior.
3. Arena 1740 Amphitheater - 7th century
1772
4. S. Anastasia
5. S. Leonardo Maggiore
6. Porta Palio (Porta Stuppa).

11. S. Maria dei Miracoli
11 (1484) Pietro Lombardo: 14th-15th
Renaissance; 1544-1550 Bar.

12. S. Giorgio Maggiore
1560 Palladio: 14th-15th. Facade.
1601: 17th century. Clenched order: 17th century
length + 2nd. 17th century + pedestal 3rd century. 14th century
1600-1605 = 17th century Baroque. 17th century
17th Proportion Bar.

13. S. Maria della Salute
1632 Longhena: 17th century. Plan
2nd-3rd century. 17th century. Effect 2nd. 17th century.
Byzantine taste; 17th century Plan
17th century. dome 17th century. 17th century
17th century Baroque.

14. Palazzo Vondranini
Facade 17th century - 17th century Baroque
17th century Baroque

15. Palazzo Pesaro.
17th century. Canal. 17th century flat roof
17th century Baroque dignity 17th century Baroque
Palazzo 17th century Baroque picturesque 17th century
17th century. characteristic 17th century Baroque
dignity 17th century Baroque
17th century Palazzo + 17th century Baroque.



R. 119-120

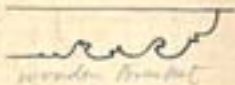

wooden bracket

7. *St. Constantine*

St. Constantine church 1892

Front 1892 - 1894 of 1892

1894, 1894, 1894, 1894, 1894

1894, 1894, 1894, 1894, 1894

1894, 1894, 1894, 1894, 1894

1894, 1894, 1894, 1894, 1894

1894, 1894, 1894, 1894, 1894

Renaissance decoration.

11. *Arch*

1894, 1894, 1894, 1894, 1894

1894, 1894, 1894, 1894, 1894

1894, 1894, 1894, 1894, 1894

1894, 1894, 1894, 1894, 1894

1894, 1894, 1894, 1894, 1894

St. Constantine church 1892



7. *Loggia*

1894, 1894, 1894, 1894, 1894

1894, 1894, 1894, 1894, 1894

1894, 1894, 1894, 1894, 1894

1894, 1894, 1894, 1894, 1894

1894, 1894, 1894, 1894, 1894

1894, 1894, 1894, 1894, 1894

1894, 1894, 1894, 1894, 1894

1894, 1894, 1894, 1894, 1894

1894, 1894, 1894, 1894, 1894

1894, 1894, 1894, 1894, 1894

1894, 1894, 1894, 1894, 1894

1894, 1894, 1894, 1894, 1894

1894, 1894, 1894, 1894, 1894

1894, 1894, 1894, 1894, 1894

1894, 1894, 1894, 1894, 1894

1894, 1894, 1894, 1894, 1894

1894, 1894, 1894, 1894, 1894

1894, 1894, 1894, 1894, 1894

1894, 1894, 1894, 1894, 1894

1894, 1894, 1894, 1894, 1894

1894, 1894, 1894, 1894, 1894

1894, 1894, 1894, 1894, 1894

1894, 1894, 1894, 1894, 1894

1894, 1894, 1894, 1894, 1894



7. *Refectory*



1894, 1894, 1894, 1894, 1894

Fresco painting + fine lines - primitive
in style.

10. 10. 10. 10. 10. 10. 10. 10. 10. 10.

F = chamber 3. 3. 3. 3. 3. 3. 3. 3. 3. 3.
Secondary windows 4. 4. 4. 4. 4. 4. 4. 4. 4. 4.
(Lambert and pointed arch vault
not)

Small + 10. 10. 10. 10. 10. 10. 10. 10. 10. 10.

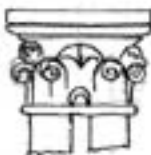

10. 10. 10. 10. 10. 10. 10. 10. 10. 10.

10. 10. 10. 10. 10. 10. 10. 10. 10. 10.

10. 10. 10. 10. 10. 10. 10. 10. 10. 10.

10. 10. 10. 10. 10. 10. 10. 10. 10. 10.

11. 11. 11. Capital - 11. 11. 11. 11. 11. 11. 11. 11. 11. 11.
dome - 11. 11. 11. 11. 11. 11. 11. 11. 11. 11.
11. 11. 11. 11. 11. 11. 11. 11. 11. 11.
11. 11. 11. 11. 11. 11. 11. 11. 11. 11.

11. Duomo

11. 11. 11. 11. 11. 11. 11. 11. 11. 11.
11. 11. 11. 11. 11. 11. 11. 11. 11. 11.
11. 11. 11. 11. 11. 11. 11. 11. 11. 11.
11. 11. 11. 11. 11. 11. 11. 11. 11. 11.
11. 11. 11. 11. 11. 11. 11. 11. 11. 11.
11. 11. 11. 11. 11. 11. 11. 11. 11. 11.

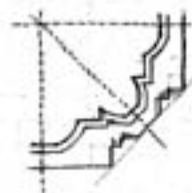

11. 11. 11. 11. 11. 11. 11. 11. 11. 11.
11. 11. 11. 11. 11. 11. 11. 11. 11. 11.
11. 11. 11. 11. 11. 11. 11. 11. 11. 11.
11. 11. 11. 11. 11. 11. 11. 11. 11. 11.

12. Duomo

Renaissance style + type of
Transsept + 10 = shift 10 10 10
Aspect of dome of the dome
11. 11. 11. 11. 11. 11. 11. 11. 11. 11.
11. 11. 11. 11. 11. 11. 11. 11. 11. 11.
11. 11. 11. 11. 11. 11. 11. 11. 11. 11.

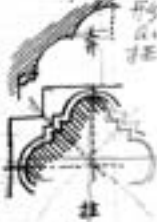

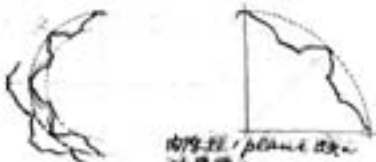

内部柱 / plane 柱
效果图

2. S. Ambrogio
 教堂, Romanesque church
 - 7. 侧面: Capital, Column
 教堂设计
 Elevation 19/1002

内部 = Schiff, 外柱为 Chaps
 重口尖拱, vault 穹顶, dome
 7 柱, Arch n 2 + round +

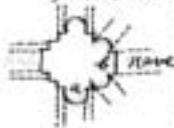

a. 内部
 b. 外部
 内部, treatment
 free of Capital etc.
 2. 穹顶, 拜占庭, Byzantine
 design 穹顶设计

dome
 穹顶, 内部, 侧壁, altar 及 柱子
 设计 Renaissance 穹顶设计
 罗马人 style / 穹顶 穹顶 穹顶 穹顶
 穹顶 Gothic 效果设计图

1. Milano
2. Duomo (11-12)
3. St. Ambrogio
4. Palazzo Reale (11-12)
5. Galleria Vittorio Emanuele
 Palazzo di Brera
 (Globe collection)
6. Ospedale Maggiore
7. Amphiteatro
 Chiesa delle Grazie
 Arco della Pace
 Frasco Cimitero Monumentale
 Chiesa di S. Satiro
 S.M. della Grazie
 Museo Poldi Pezzoli

(1) Duomo

一、穹顶, 大穹顶, detail, 穹顶
 研究, 穹顶, 穹顶, 穹顶, 穹顶
 内部, 穹顶, 穹顶, 穹顶, 穹顶
 穹顶, 穹顶, 穹顶, 穹顶, 穹顶
 穹顶, 穹顶, 穹顶, 穹顶, 穹顶
 穹顶, 穹顶, 穹顶, 穹顶, 穹顶
 穹顶, 穹顶, 穹顶, 穹顶, 穹顶
 穹顶, 穹顶, 穹顶, 穹顶, 穹顶

Nasipell

1. Renaissance 15th & 16th C.
 2. Facade of Holy Spirit 1500
 painted arch, 16th C. facade
 3. 1500-1550 1500-1550
 painted arch 1500-1550
 Renaissance 15th & 16th C.

Italy

1. Chapel - 7 pictures 15th C.
 2. Bramante - Renaissance
 3. 15th C. facade perfection 15th C.
 15th C. facade perfection 15th C.



1. Renaissance 15th & 16th C.
 2. Facade of Holy Spirit 1500
 painted arch, 16th C. facade

3. 1500-1550 1500-1550
 painted arch 1500-1550
 Renaissance 15th & 16th C.

4. Facade of Holy Spirit 1500
 painted arch, 16th C. facade

5. Facade of Holy Spirit 1500
 painted arch, 16th C. facade

6. Facade of Holy Spirit 1500
 painted arch, 16th C. facade

7. Facade of Holy Spirit 1500
 painted arch, 16th C. facade

8. Facade of Holy Spirit 1500
 painted arch, 16th C. facade

9. Facade of Holy Spirit 1500
 painted arch, 16th C. facade

St. Thomas. Romanesque
& Schiff



naue 12

mit
Überlappung

5 Schiff & 5 D., Gothic vault,
architekt. arch. 135 naue 7:1
H. 12:11.79.

Strasbourg

Münster.
Romanesque plan & 20
Gothic. 14 1320 1307. 91

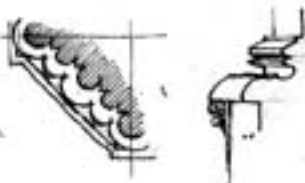

Handwritten text at the top of the left page, possibly a title or location name.

Heidelberg Schloss

2. 3. 4. 5. 6. 7. 8. 9. 10. 11. 12. 13. 14. 15. 16. 17. 18. 19. 20. 21. 22. 23. 24. 25. 26. 27. 28. 29. 30. 31. 32. 33. 34. 35. 36. 37. 38. 39. 40. 41. 42. 43. 44. 45. 46. 47. 48. 49. 50. 51. 52. 53. 54. 55. 56. 57. 58. 59. 60. 61. 62. 63. 64. 65. 66. 67. 68. 69. 70. 71. 72. 73. 74. 75. 76. 77. 78. 79. 80. 81. 82. 83. 84. 85. 86. 87. 88. 89. 90. 91. 92. 93. 94. 95. 96. 97. 98. 99. 100.



Abakus, so-called Gesimse



Ante Temple, Temple
Rome 1810, 1812, 1813, 1814, 1815.



As proportion 1/2

Prison
Athens Temple, St. (Sonia) etc.



Berlin
Königliches Museum

Prison, Stiefmännchen 1710, 1711
Syrische Stiefmännchen

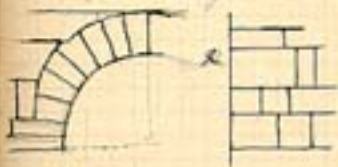

As proportion 1/2

Berlin Stiefmännchen, 1710, 1711
1810-1811





Figure 1 - 1886 (Kantakalpa)

7-1-1886



183



Edessa

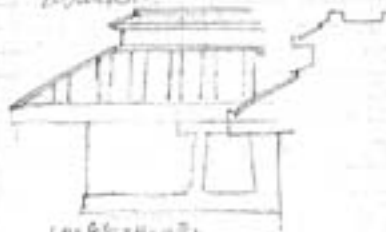

105 & 106/2

Gantou 68

- N. 200, Tringon, Myx, Aster, 9+
- Bootes, Parkman, Grim, b,
- Leard, Kanton, Lignier, b,
- Polydorus, Dion, f, Gues, b,
- Chloris, b, Lignier, f,
- Altaia, Nisse, f, f, f, Altaia, f,
- Mignons, b, Perphiston, b,
- Leu, b, Heracles, Hebe, Hera, f,
- Sepharates, Myron, Demeter,
- Erasmont, Aphantes, Apollon, b,
- Trojan, b, b, Artemis, f,
- Artemon, f, b, b, b, b, f,
- N. 200, b,
- N. 200, Altaia, Thales, Thales, b, b, b,
- Althos, Leon, Memora, Cos, f,
- Thia, Helios,

Kunstgewerke Museum
 Potsdam 1871 1872, 1873 1874 1875 1876
 1877



1871 1872 1873 1874 1875 1876

1877

1878 1879 1880 1881 1882 1883

1884 1885 1886 1887 1888 1889

1890 1891 1892 1893 1894 1895

1896 1897 1898 1899 1900 1901

1902 1903 1904 1905 1906 1907

1908 1909 1910 1911 1912 1913

1914 1915 1916 1917 1918 1919

1920 1921 1922 1923 1924 1925



1871-1872

Cöln

127

人口三十五萬大寺あり

Potsdam
 Kunstgewerke Museum

1871-1872



1873

1874

1875

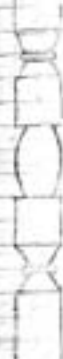

1876

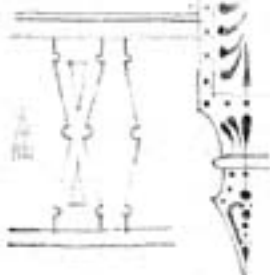

1877

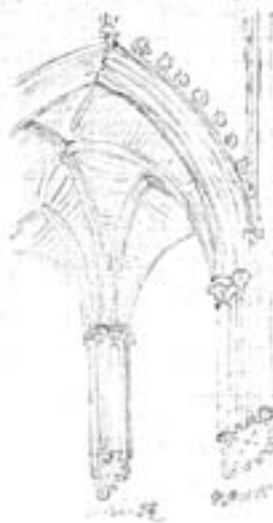

Arch. 11



1800/19
1800/19
1800/19

1800/19
1800/19
1800/19
1800/19
1800/19

abome gū lōlu



中央口大柱

1800/19
1800/19
1800/19
1800/19

1800/19
1800/19
1800/19
1800/19



Grado, S. Maria
 Romanesque style: 12-13 Century
 2.5.18m. + R. dome. 11.10.11.14.15.16.17.18.19.20.21.22.23.24.25.26.27.28.29.30.31.32.33.34.35.36.37.38.39.40.41.42.43.44.45.46.47.48.49.50.51.52.53.54.55.56.57.58.59.60.61.62.63.64.65.66.67.68.69.70.71.72.73.74.75.76.77.78.79.80.81.82.83.84.85.86.87.88.89.90.91.92.93.94.95.96.97.98.99.100.

Palace
 - 7000 + Gothic style of 12th - 14th century

Griggenich
 1141-1172 S. Palastkirche

St. Gerold
 1219-1274

- Stadtkirche Rossum:
1. Dombau 13. - 14. Jhd.
 2. Turm 14. Jhd.
 3. Apsis 14. - 15. Jhd.
 4. Chor 15. Jhd.

St. Maria in Capital
 Romanesque style

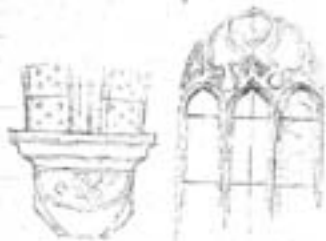

1180 + 12 - 13th century
 12th - 13th century
 Romanesque - Byzantine
 11.10.11.14.15.16.17.18.19.20.21.22.23.24.25.26.27.28.29.30.31.32.33.34.35.36.37.38.39.40.41.42.43.44.45.46.47.48.49.50.51.52.53.54.55.56.57.58.59.60.61.62.63.64.65.66.67.68.69.70.71.72.73.74.75.76.77.78.79.80.81.82.83.84.85.86.87.88.89.90.91.92.93.94.95.96.97.98.99.100.

Alte Kirche III C. 185

Romanesque + 12th century ceiling &
 1180 + 12 - 13th century - Gothic arch - 12th
 12th century - 13th century
 11.10.11.14.15.16.17.18.19.20.21.22.23.24.25.26.27.28.29.30.31.32.33.34.35.36.37.38.39.40.41.42.43.44.45.46.47.48.49.50.51.52.53.54.55.56.57.58.59.60.61.62.63.64.65.66.67.68.69.70.71.72.73.74.75.76.77.78.79.80.81.82.83.84.85.86.87.88.89.90.91.92.93.94.95.96.97.98.99.100.

Notes some



side / side 22 (20)

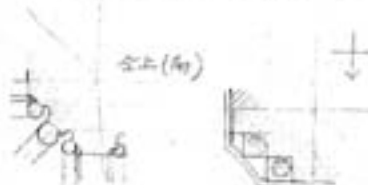

22 (20)

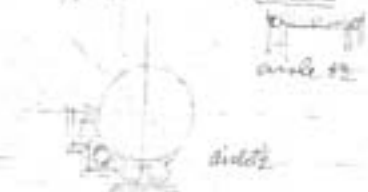

side 22

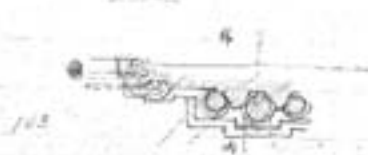

103

- Book-store of arts.
especially architecture
- Bateford, 2-5-10
94. totigle-Halborn.
- 3 pav. 500. (Lansing) W.C.
- Campbell. (general) plate
- 24th, near British Museum
- Studio magazine of art, architectural Review, Art and Craft, B. News, Builder's journal, (Stone) quarry, Dearath's & painter's journal
- British architect
- Builder
- Burlington magazine.
- Connoisseurs.

Music Luxembourg

nave 控

diave = 方 = 控 控



airle = 冲 控 控

冲 = 冲 控 冲 控





147

Musée Clong



K 213



dessins de bois, aut. de Des-Perins
11^e siècle.
115. 116. 117. 118. 119. 120. 121. 122. 123.
124. 125. 126. 127. 128. 129. 130. 131. 132. 133. 134. 135. 136. 137. 138. 139. 140. 141. 142. 143. 144. 145. 146. 147. 148. 149. 150. 151. 152. 153. 154. 155. 156. 157. 158. 159. 160. 161. 162. 163. 164. 165. 166. 167. 168. 169. 170. 171. 172. 173. 174. 175. 176. 177. 178. 179. 180. 181. 182. 183. 184. 185. 186. 187. 188. 189. 190. 191. 192. 193. 194. 195. 196. 197. 198. 199. 200.

Leucore
 Assyrian Museion
 Khorsabad, palais de Sargon III.
 Le Roi Assur-Bani-Habal, plan
 de Ninive III.C
 1845-1850. Musée de Paris
 1. 1845-1850. Musée de Paris
 Challe 32-30. B.C. 1. 1845-1850
 Statue 77.
 S. 1845.



707

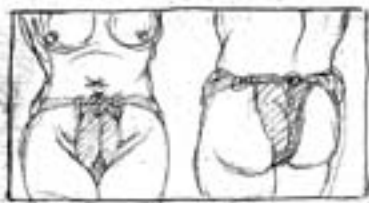

Mt. Pelion de Larina I.

Canal del N. a la Mar Ponga.
en Pasaia. 1851 m. 220. S. de Larina
is Chel. Argia de 1851 m. 220. S. de Larina
1851 m. 220. S. de Larina.

Larina de Pasaia - Argia. 1851 m. 220.
Chel de Larina. 1851 m. 220. S. de Larina.
1851 m. 220. S. de Larina.

Phonice 1851 m. 220. S. de Larina.
Inscription: Helene & 24. 1851 m. 220.

1. In the gate of Temple found at
Larina near Chel (1851 m. 220).
1851 m. 220. S. de Larina. Architecture
in Larina de Larina. 1851 m. 220. S. de Larina.
1851 m. 220. S. de Larina.

1. Larina (Minares) 1851 m. 220.
Palmyra de 1851 m. 220. S. de Larina.
1851 m. 220. S. de Larina.

1. Larina (Minares) 1851 m. 220.
Inscription: Helene & 24. 1851 m. 220.
1851 m. 220. S. de Larina.

1. Larina (Minares) 1851 m. 220.
Inscription: Helene & 24. 1851 m. 220.
1851 m. 220. S. de Larina.

1. Larina (Minares) 1851 m. 220.
Inscription: Helene & 24. 1851 m. 220.
1851 m. 220. S. de Larina.

1. Larina (Minares) 1851 m. 220.
Inscription: Helene & 24. 1851 m. 220.
1851 m. 220. S. de Larina.

Suce

Suce. 1851 m. 220. S. de Larina.
1851 m. 220. S. de Larina.
1851 m. 220. S. de Larina.



o Pessia.

Israël, Aphrodite (Salle des Hébreux)
d'Alexandrie (1019, B.C.) modèle 05

o Gréco-Phénicienne, 180, plâtre
H. 11.20 - L. 11.00 - P. 11.00
H. 20 - L. 11.00 - P. 11.00



Trappe de bois de Famagouste
chapiteau Cypriote sculpté sur une
base carrée.

o Ailette

o Magnésie de Méandre

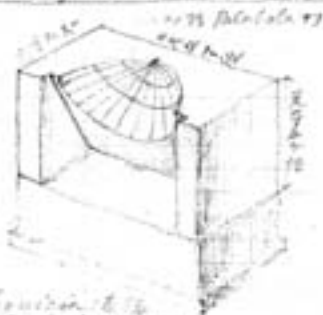

Phénicien, 180

Ouvr. de l'architecte
cadre de bronze, sculpté par le
colonel L. L. L.

S. Sioni

S. German.

Eglise S. Severin
à côté l'église Saint Julien la
Rivière

S. Jacque

Levres

Versaille

Cimetière

Tombeau de Napoléon I.

Eiffel tower

Opera.

S. Glysee

Palais Royal

Arche de Triomphe

Gare de Annai

Musée Guimet.

Triennale

Salon at Grande Palais

图15 拱道-357

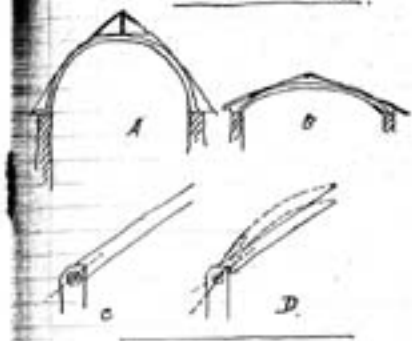

拱部，每出肋一装饰性
肋，每肋出肋，每肋肋
肋，每肋肋，每肋肋，每肋肋
肋，每肋肋。

Theatre:

Salaberon:

La Dame aux Camélias (特別)

純然の浮世の男女の情の苦痛の足るものなり
一巻と二巻にわたる物語 155 - 156
Creditors 4/24 挿録 1874 1875
1876 1877

Concert:

Fortelge.

Variete:

Palisiana.

1877

Opera:

Tristan & Isolde

2/2

LONDON

British Museum.

Journal of the British Museum. P. 74. Jones.

1877.

Sassanid
Indo-Sassanid
Sogho-Persian
Sogho-Sassanid
Soghoic.
Indo-Sogho-Græc
Mongol
Græco-Indian
Græc.
Græco-Bactrian
Græco-Roman
Indo-Bactro-Persian
Indo-Soghoic
Roman.
Indo-Buddhist.
Indian.
Sogho-Parthian
Indo-Mongolian.
+ +
12-1877-1878

Sassanid
Indian
Soghoic
Roman
Græc
Bactrian
Parthian
Buddhist
Mongolian

Indo-Buddhist
Indo-Persian
Indo-Soghoic
Indo-Mongolian



A
 石塔與高塔
 看：石塔高塔
 陰式式：石塔
 277見

222
 S. W. Corner of Rawak Stupa
 Court from the outside, showing
 colossal statues of Buddhas (circa 4th
 Century A. D.) & carved in the style of
 Gandhara art. The figures are seated in
 the typical meditative posture.

Report of Geographical & Archaeological
 Exploration in Chinese-
 Turkistan by M. H. Stein, Ph. D.
 1902.



Ancient seals in stone
 & brass, from ruined
 sites of Khotan &
 Baklanakan.

支那文書 見八〇〇年
 大曆十年二月
 貞元六年
 大曆十七年
 建中三年七月十二日

又一文書 見八〇〇年
 7. 他, document, 西曆文書, 大曆文書
 及唐文書 9. 〇〇, 唐文書, 大曆文書.

Sculptures:

Reliefs image in stucco representing
 Buddha or Bodhisattvas (circa 300-400
 A.D.) from the court of colonial stupa excavated
 at the S.W. Corner of Rawak Stupa, Khotan.
 By Dr. M. H. Stein, April 1901.
 7. 1. 石塔 8. 2. 西曆文書
 7. 1. 石塔 8. 2. 西曆文書



この像は、隋代の造像で、
 漢代の造像より、
 漢式に似て、
 漢式に似て、
 漢式に似て、



20 Sculpture in pure Chinese style.
 A in Gandhara style - 27
 A' in the style of B - 27
 in the style of B

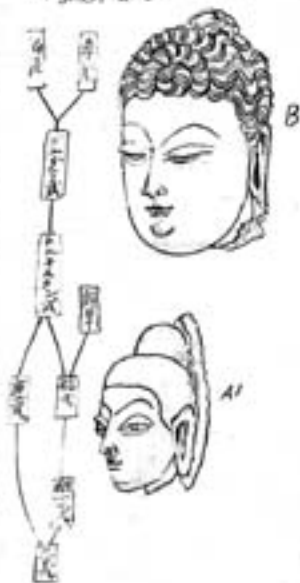

4.2. = *diversifolia*
 尾沙乃尺 = *Vitis macranthera* or *glauca*
 沙大 = *Vitis rotundifolia*
 廣目天 = *Vitis rotundifolia*
 沙大 =
 梨合 = *Vitis californica*
 沙大 = *adpressata*

The Treasures of the Oxus

Persian list dating from the 9th century
 A.C. 700 + 1000 + 1500 + 2000 + 2500
 1. *de la* ...
 2000

Sassanian, 1000 + 1500 + 2000
 2. *de la* ...
 (A.C.) 1000 A.D. 1500 + 2000
 Bahramgush, 1000 + 1500
 Mazandaran, Byzantium 1000
 Armenia 1000

Mazandaran 1000 + 1500 + 2000
 3. *de la* ...
 1000 + 1500 + 2000 + 2500 + 3000

4. *de la* ...
 1000 + 1500 + 2000 + 2500 + 3000
 1. *de la* ...

- Print Room
1. *de la* ...
 2. *de la* ...
 3. *de la* ...
 4. *de la* ...
 5. *de la* ...
 6. *de la* ...
 7. *de la* ...
 8. *de la* ...
 9. *de la* ...
10. *de la* ...
 11. *de la* ...
 12. *de la* ...
 13. *de la* ...

Reading room

1. *de la* ...
 2. *de la* ...
 3. *de la* ...
 4. *de la* ...
 5. *de la* ...
 6. *de la* ...
 7. *de la* ...
 8. *de la* ...
 9. *de la* ...
 10. *de la* ...



arch. + Non-Monday



817

8178 Slings, some 10 1/2
No 2

8178 Slings 40-50
3-5 1/2 5-10 10-15
1 1/2 1 1/2 2 1/2



8178
Selling
Garden
Lawn
1-10-12
1/2

Natural History Museum

8178 Slings, Johnson + 1110, Kege
1/2 1/2 1/2 1/2 1/2
1 1/2 1 1/2 1 1/2

Ely Cathedral

1st Norman or Early English,
Decorated style, Perpendicular style
1/2 1/2 1/2 1/2 1/2
1 1/2 1 1/2 1 1/2

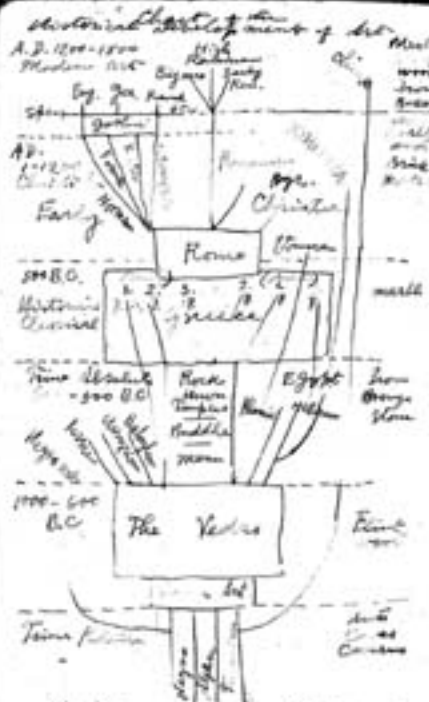

A Manual of the Historical Development of Art. by J.J. Koefler. 1976.

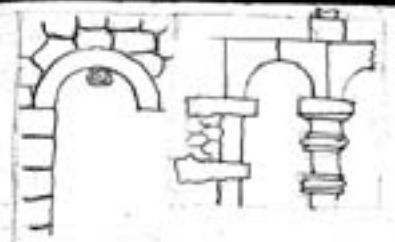

'Saxon Tower'

Cambridge

Arch & tower built 1120-1130
 5-6th c. Saxon tower
 11th c. Norman tower
 12th c. Norman tower

Prof. Walther's
 Science of Classical Antiquity

(A) Words Monument Events
 Philology Archaeology History

Form Content
 (Philology) Literature
 Grammar Philology

(B) Words Monuments Events
 Epigraphy Topography

(C) Words Monuments Events
 Antiquities

- 本邦書
 1. Handbook of Greek Sculpture
 by Gardner
 2. History of Greek Art.
 3. Geschichte der Griech. Plastik.

中 附 頁 13, 12

| 1874 | 187 420 | 200 | 220 | 250 | 270 |
|------------|---------|----------|-------|----------|-----|
| Alcibiades | Them. | Mytilene | Them. | Mytilene | |





Ely Cathedral.

A 1071, Capital -
painting
B 1071, Arch -
sculpt.

B 1071, 2nd Arch
1071, 2nd Arch
Arabic or Gothic
1071, 2nd Arch
1071.

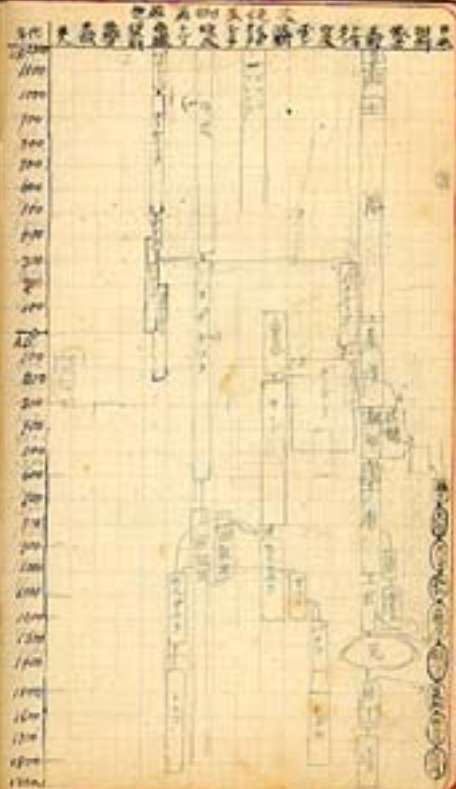

Oxford,

1. Christ Church = + 2:1 College +
2:1 1000, 1400, 1500, 1600, 1700.
Cathedral - Norman Cruciform, early
English, decorated, Perpendicular.
12th, 13th, 14th, 15th, 16th, 17th, 18th, 19th, 20th, 21st, 22nd, 23rd, 24th, 25th, 26th, 27th, 28th, 29th, 30th, 31st, 32nd, 33rd, 34th, 35th, 36th, 37th, 38th, 39th, 40th, 41st, 42nd, 43rd, 44th, 45th, 46th, 47th, 48th, 49th, 50th, 51st, 52nd, 53rd, 54th, 55th, 56th, 57th, 58th, 59th, 60th, 61st, 62nd, 63rd, 64th, 65th, 66th, 67th, 68th, 69th, 70th, 71st, 72nd, 73rd, 74th, 75th, 76th, 77th, 78th, 79th, 80th, 81st, 82nd, 83rd, 84th, 85th, 86th, 87th, 88th, 89th, 90th, 91st, 92nd, 93rd, 94th, 95th, 96th, 97th, 98th, 99th, 100th.
15th, 16th, 17th, 18th, 19th, 20th, 21st, 22nd, 23rd, 24th, 25th, 26th, 27th, 28th, 29th, 30th, 31st, 32nd, 33rd, 34th, 35th, 36th, 37th, 38th, 39th, 40th, 41st, 42nd, 43rd, 44th, 45th, 46th, 47th, 48th, 49th, 50th, 51st, 52nd, 53rd, 54th, 55th, 56th, 57th, 58th, 59th, 60th, 61st, 62nd, 63rd, 64th, 65th, 66th, 67th, 68th, 69th, 70th, 71st, 72nd, 73rd, 74th, 75th, 76th, 77th, 78th, 79th, 80th, 81st, 82nd, 83rd, 84th, 85th, 86th, 87th, 88th, 89th, 90th, 91st, 92nd, 93rd, 94th, 95th, 96th, 97th, 98th, 99th, 100th.
Kitchen + 21 arrangement - 12th, 13th, 14th, 15th, 16th, 17th, 18th, 19th, 20th, 21st, 22nd, 23rd, 24th, 25th, 26th, 27th, 28th, 29th, 30th, 31st, 32nd, 33rd, 34th, 35th, 36th, 37th, 38th, 39th, 40th, 41st, 42nd, 43rd, 44th, 45th, 46th, 47th, 48th, 49th, 50th, 51st, 52nd, 53rd, 54th, 55th, 56th, 57th, 58th, 59th, 60th, 61st, 62nd, 63rd, 64th, 65th, 66th, 67th, 68th, 69th, 70th, 71st, 72nd, 73rd, 74th, 75th, 76th, 77th, 78th, 79th, 80th, 81st, 82nd, 83rd, 84th, 85th, 86th, 87th, 88th, 89th, 90th, 91st, 92nd, 93rd, 94th, 95th, 96th, 97th, 98th, 99th, 100th.
2:1 15th, 16th, 17th, 18th, 19th, 20th, 21st, 22nd, 23rd, 24th, 25th, 26th, 27th, 28th, 29th, 30th, 31st, 32nd, 33rd, 34th, 35th, 36th, 37th, 38th, 39th, 40th, 41st, 42nd, 43rd, 44th, 45th, 46th, 47th, 48th, 49th, 50th, 51st, 52nd, 53rd, 54th, 55th, 56th, 57th, 58th, 59th, 60th, 61st, 62nd, 63rd, 64th, 65th, 66th, 67th, 68th, 69th, 70th, 71st, 72nd, 73rd, 74th, 75th, 76th, 77th, 78th, 79th, 80th, 81st, 82nd, 83rd, 84th, 85th, 86th, 87th, 88th, 89th, 90th, 91st, 92nd, 93rd, 94th, 95th, 96th, 97th, 98th, 99th, 100th.
2. Radcliffe Camera - Library +
round building - Renaissance
style + 17th.
3. Indian Institute or Indian
Museum 17th, 18th, 19th, 20th, 21st, 22nd, 23rd, 24th, 25th, 26th, 27th, 28th, 29th, 30th, 31st, 32nd, 33rd, 34th, 35th, 36th, 37th, 38th, 39th, 40th, 41st, 42nd, 43rd, 44th, 45th, 46th, 47th, 48th, 49th, 50th, 51st, 52nd, 53rd, 54th, 55th, 56th, 57th, 58th, 59th, 60th, 61st, 62nd, 63rd, 64th, 65th, 66th, 67th, 68th, 69th, 70th, 71st, 72nd, 73rd, 74th, 75th, 76th, 77th, 78th, 79th, 80th, 81st, 82nd, 83rd, 84th, 85th, 86th, 87th, 88th, 89th, 90th, 91st, 92nd, 93rd, 94th, 95th, 96th, 97th, 98th, 99th, 100th.
17th, 18th, 19th, 20th, 21st, 22nd, 23rd, 24th, 25th, 26th, 27th, 28th, 29th, 30th, 31st, 32nd, 33rd, 34th, 35th, 36th, 37th, 38th, 39th, 40th, 41st, 42nd, 43rd, 44th, 45th, 46th, 47th, 48th, 49th, 50th, 51st, 52nd, 53rd, 54th, 55th, 56th, 57th, 58th, 59th, 60th, 61st, 62nd, 63rd, 64th, 65th, 66th, 67th, 68th, 69th, 70th, 71st, 72nd, 73rd, 74th, 75th, 76th, 77th, 78th, 79th, 80th, 81st, 82nd, 83rd, 84th, 85th, 86th, 87th, 88th, 89th, 90th, 91st, 92nd, 93rd, 94th, 95th, 96th, 97th, 98th, 99th, 100th.
Burmese 17th, 18th, 19th, 20th, 21st, 22nd, 23rd, 24th, 25th, 26th, 27th, 28th, 29th, 30th, 31st, 32nd, 33rd, 34th, 35th, 36th, 37th, 38th, 39th, 40th, 41st, 42nd, 43rd, 44th, 45th, 46th, 47th, 48th, 49th, 50th, 51st, 52nd, 53rd, 54th, 55th, 56th, 57th, 58th, 59th, 60th, 61st, 62nd, 63rd, 64th, 65th, 66th, 67th, 68th, 69th, 70th, 71st, 72nd, 73rd, 74th, 75th, 76th, 77th, 78th, 79th, 80th, 81st, 82nd, 83rd, 84th, 85th, 86th, 87th, 88th, 89th, 90th, 91st, 92nd, 93rd, 94th, 95th, 96th, 97th, 98th, 99th, 100th.

Peterboro Cathedral

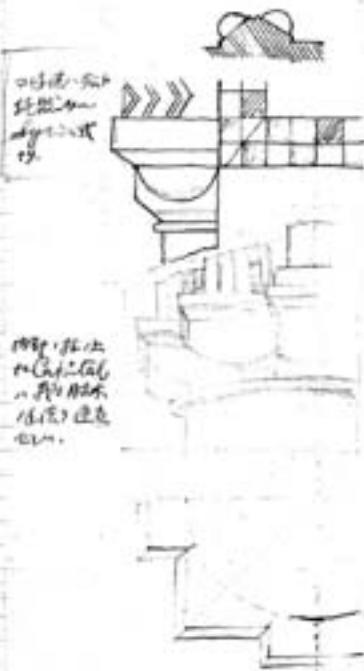

Stony church (1905) 17

Stony church - 17. 1905
11. 18. 1905 - 11. 1905
12. 1905 - 12. 1905
13. 1905 - 13. 1905
14. 1905 - 14. 1905
15. 1905 - 15. 1905
16. 1905 - 16. 1905
17. 1905 - 17. 1905
18. 1905 - 18. 1905
19. 1905 - 19. 1905
20. 1905 - 20. 1905
21. 1905 - 21. 1905
22. 1905 - 22. 1905
23. 1905 - 23. 1905
24. 1905 - 24. 1905
25. 1905 - 25. 1905
26. 1905 - 26. 1905
27. 1905 - 27. 1905
28. 1905 - 28. 1905
29. 1905 - 29. 1905
30. 1905 - 30. 1905
31. 1905 - 31. 1905
32. 1905 - 32. 1905
33. 1905 - 33. 1905
34. 1905 - 34. 1905
35. 1905 - 35. 1905
36. 1905 - 36. 1905
37. 1905 - 37. 1905
38. 1905 - 38. 1905
39. 1905 - 39. 1905
40. 1905 - 40. 1905
41. 1905 - 41. 1905
42. 1905 - 42. 1905
43. 1905 - 43. 1905
44. 1905 - 44. 1905
45. 1905 - 45. 1905
46. 1905 - 46. 1905
47. 1905 - 47. 1905
48. 1905 - 48. 1905
49. 1905 - 49. 1905
50. 1905 - 50. 1905
51. 1905 - 51. 1905
52. 1905 - 52. 1905
53. 1905 - 53. 1905
54. 1905 - 54. 1905
55. 1905 - 55. 1905
56. 1905 - 56. 1905
57. 1905 - 57. 1905
58. 1905 - 58. 1905
59. 1905 - 59. 1905
60. 1905 - 60. 1905
61. 1905 - 61. 1905
62. 1905 - 62. 1905
63. 1905 - 63. 1905
64. 1905 - 64. 1905
65. 1905 - 65. 1905
66. 1905 - 66. 1905
67. 1905 - 67. 1905
68. 1905 - 68. 1905
69. 1905 - 69. 1905
70. 1905 - 70. 1905
71. 1905 - 71. 1905
72. 1905 - 72. 1905
73. 1905 - 73. 1905
74. 1905 - 74. 1905
75. 1905 - 75. 1905
76. 1905 - 76. 1905
77. 1905 - 77. 1905
78. 1905 - 78. 1905
79. 1905 - 79. 1905
80. 1905 - 80. 1905
81. 1905 - 81. 1905
82. 1905 - 82. 1905
83. 1905 - 83. 1905
84. 1905 - 84. 1905
85. 1905 - 85. 1905
86. 1905 - 86. 1905
87. 1905 - 87. 1905
88. 1905 - 88. 1905
89. 1905 - 89. 1905
90. 1905 - 90. 1905
91. 1905 - 91. 1905
92. 1905 - 92. 1905
93. 1905 - 93. 1905
94. 1905 - 94. 1905
95. 1905 - 95. 1905
96. 1905 - 96. 1905
97. 1905 - 97. 1905
98. 1905 - 98. 1905
99. 1905 - 99. 1905
100. 1905 - 100. 1905



Stony church (1905) 17
1905 - 17. 1905
18. 1905 - 18. 1905
19. 1905 - 19. 1905
20. 1905 - 20. 1905
21. 1905 - 21. 1905
22. 1905 - 22. 1905
23. 1905 - 23. 1905
24. 1905 - 24. 1905
25. 1905 - 25. 1905
26. 1905 - 26. 1905
27. 1905 - 27. 1905
28. 1905 - 28. 1905
29. 1905 - 29. 1905
30. 1905 - 30. 1905
31. 1905 - 31. 1905
32. 1905 - 32. 1905
33. 1905 - 33. 1905
34. 1905 - 34. 1905
35. 1905 - 35. 1905
36. 1905 - 36. 1905
37. 1905 - 37. 1905
38. 1905 - 38. 1905
39. 1905 - 39. 1905
40. 1905 - 40. 1905
41. 1905 - 41. 1905
42. 1905 - 42. 1905
43. 1905 - 43. 1905
44. 1905 - 44. 1905
45. 1905 - 45. 1905
46. 1905 - 46. 1905
47. 1905 - 47. 1905
48. 1905 - 48. 1905
49. 1905 - 49. 1905
50. 1905 - 50. 1905
51. 1905 - 51. 1905
52. 1905 - 52. 1905
53. 1905 - 53. 1905
54. 1905 - 54. 1905
55. 1905 - 55. 1905
56. 1905 - 56. 1905
57. 1905 - 57. 1905
58. 1905 - 58. 1905
59. 1905 - 59. 1905
60. 1905 - 60. 1905
61. 1905 - 61. 1905
62. 1905 - 62. 1905
63. 1905 - 63. 1905
64. 1905 - 64. 1905
65. 1905 - 65. 1905
66. 1905 - 66. 1905
67. 1905 - 67. 1905
68. 1905 - 68. 1905
69. 1905 - 69. 1905
70. 1905 - 70. 1905
71. 1905 - 71. 1905
72. 1905 - 72. 1905
73. 1905 - 73. 1905
74. 1905 - 74. 1905
75. 1905 - 75. 1905
76. 1905 - 76. 1905
77. 1905 - 77. 1905
78. 1905 - 78. 1905
79. 1905 - 79. 1905
80. 1905 - 80. 1905
81. 1905 - 81. 1905
82. 1905 - 82. 1905
83. 1905 - 83. 1905
84. 1905 - 84. 1905
85. 1905 - 85. 1905
86. 1905 - 86. 1905
87. 1905 - 87. 1905
88. 1905 - 88. 1905
89. 1905 - 89. 1905
90. 1905 - 90. 1905
91. 1905 - 91. 1905
92. 1905 - 92. 1905
93. 1905 - 93. 1905
94. 1905 - 94. 1905
95. 1905 - 95. 1905
96. 1905 - 96. 1905
97. 1905 - 97. 1905
98. 1905 - 98. 1905
99. 1905 - 99. 1905
100. 1905 - 100. 1905



University Museum

Schubert & Taylor's Museum

| | | | | |
|-----------|--------|----|------|--------|
| Departure | Kiv. | 19 | 0.00 | Call's |
| Apr. | Nass. | 27 | 1.00 | Call's |
| May | Nass. | 9 | 1.00 | |
| June | Nass. | 10 | 1.00 | |
| July | " | 12 | 1.00 | |
| Oct. | Yokoh. | 25 | 1.00 | Call's |

Chuta Ito.

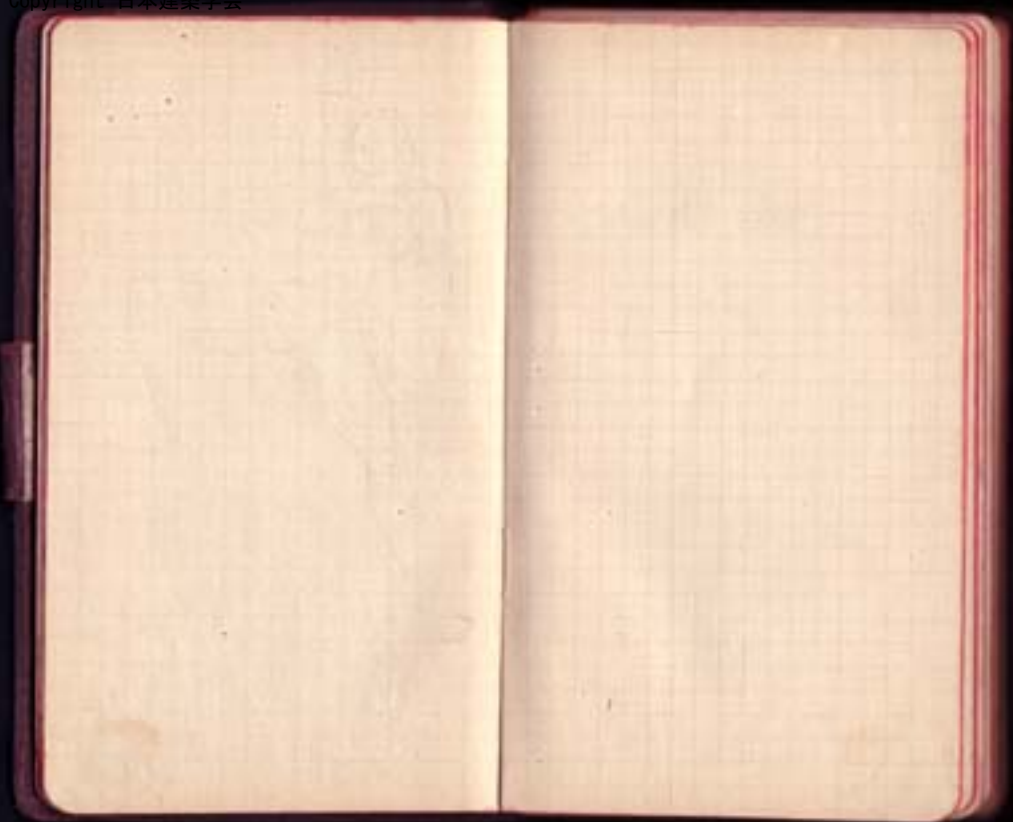

- Victoria station
 à Geneva st. Cal = 2/4
 ○ Eastward alibi.
 (Bank) 1^o

- Victoria station.
 Victoria station.
 chorio grass, national
 portrait gallery, to street
 gallery. St. Martin's church
 in Dinsdag square. - 1^o
 white hall, (base square)
 78, white hall (knige square)
 in Parcival square. 12
 new chamber at building
 to new square. 10.
 parliament 72. 11
 new building alibi. 1914
 Victoria street. 9 11
 11 + 13 = 24
 12 + 11 = 23
 13 + 10 = 23
 14 + 9 = 23
 15 + 8 = 23
 16 + 7 = 23
 17 + 6 = 23
 18 + 5 = 23
 19 + 4 = 23
 20 + 3 = 23
 21 + 2 = 23
 22 + 1 = 23
 4. Grosvenor Garden
 S. W.

Miss Hall
 150 West 84th street.
 New York City.
 每星期一及星期五一週 75¢

20. 11. Bernard

21. 11. 13
 13. 11. 13

中 橋 街
 11. 11. 13
 11. 11. 13
 11. 11. 13

Margon Jurski
 Ul. Dabrowskiego 4.
 Lemberg, Galicia.
 Austria.

F. Augimari
 Stanley Gordon 44
 Hampstead.

九月來
 本埠
 Hamore, am Klemen Felde
 32

Hôtel Safflot
9. Foullet. Paris

11. S. G. ... Paris

Japanese Legation
Mamech. Paris

14. ... Paris

15. ... Paris

16. ... Paris

17. ... Paris

18. Rue de ... 20.

19. ... 125

20. ... 104

S. Yamakawa
Bayreuthstr. 29

15 Brandeis

Mrs. Mason 1860
L... 182.70

M. Bischoff

33 Rue ...

Hilfstr. 18. 1/2

13. ...

...

...

...

...

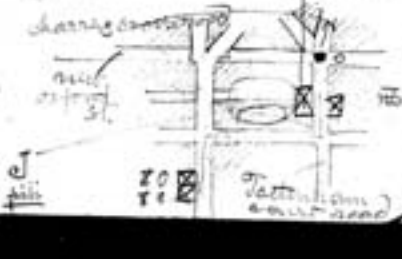

| | 右 | 左 |
|---------------|----------------------------------|----------------------------------|
| 中袋様一升
伊豆白木 | 西子中袋子
中子中袋子
中子中袋子
中子中袋子 | 西子中袋子
中子中袋子
中子中袋子
中子中袋子 |



Reference books:

1. Early History of India including Alexander's Campaigns.
F. A. Smith (expd.)
 2. The story of the Nations
Buddhist India
by Rhys Davids.
 3. Weltgeschichte - Charakteristiken
'König Asoka'
von Edmund Hardy (1907).
 4. Ancient India
its invasion by Alexander the
great. Mc Crindle.
 5. Die Götter der Griechen
F. G. G. G. G.
-
- deutsche Kunst & Architektur
A 11 11 11 - 11 11 11
6. Theory & Analysis of Ornament
by Schenckmann
 7. Theory & practice of Design
Franklin Jackson
 8. Handbook of Ornament
Meyer.
 9. Gwilt's Encyclopaedia of
Architecture
 10. Building Code.
 11. Dictionary of Art.

Floriz. = Palazzo Hotel

Wendig = Victoria Hotel

Van = Jack de Noor.

Istituto di Belle Arti

(Via Ripetta)

Direttore: Prof. Comm. Rossi

Wienyffeler 25. 38^e
by F. de Noor

收入
 1. 20.00
 2. 10.00
 3. 5.00
 4. 15.00
 5. 10.00
 6. 20.00
 7. 15.00
 8. 10.00
 9. 5.00
 10. 10.00
 11. 15.00
 12. 10.00
 13. 5.00
 14. 10.00
 15. 15.00
 16. 10.00
 17. 5.00
 18. 10.00
 19. 15.00
 20. 10.00
 21. 5.00
 22. 10.00
 23. 15.00
 24. 10.00
 25. 5.00
 26. 10.00
 27. 15.00
 28. 10.00
 29. 5.00
 30. 10.00
 31. 15.00
 32. 10.00
 33. 5.00
 34. 10.00
 35. 15.00
 36. 10.00
 37. 5.00
 38. 10.00
 39. 15.00
 40. 10.00
 41. 5.00
 42. 10.00
 43. 15.00
 44. 10.00
 45. 5.00
 46. 10.00
 47. 15.00
 48. 10.00
 49. 5.00
 50. 10.00
 51. 15.00
 52. 10.00
 53. 5.00
 54. 10.00
 55. 15.00
 56. 10.00
 57. 5.00
 58. 10.00
 59. 15.00
 60. 10.00
 61. 5.00
 62. 10.00
 63. 15.00
 64. 10.00
 65. 5.00
 66. 10.00
 67. 15.00
 68. 10.00
 69. 5.00
 70. 10.00
 71. 15.00
 72. 10.00
 73. 5.00
 74. 10.00
 75. 15.00
 76. 10.00
 77. 5.00
 78. 10.00
 79. 15.00
 80. 10.00
 81. 5.00
 82. 10.00
 83. 15.00
 84. 10.00
 85. 5.00
 86. 10.00
 87. 15.00
 88. 10.00
 89. 5.00
 90. 10.00
 91. 15.00
 92. 10.00
 93. 5.00
 94. 10.00
 95. 15.00
 96. 10.00
 97. 5.00
 98. 10.00
 99. 15.00
 100. 10.00

支出
 1. 20.00
 2. 10.00
 3. 5.00
 4. 15.00
 5. 10.00
 6. 20.00
 7. 15.00
 8. 10.00
 9. 5.00
 10. 10.00
 11. 15.00
 12. 10.00
 13. 5.00
 14. 10.00
 15. 15.00
 16. 10.00
 17. 5.00
 18. 10.00
 19. 15.00
 20. 10.00
 21. 5.00
 22. 10.00
 23. 15.00
 24. 10.00
 25. 5.00
 26. 10.00
 27. 15.00
 28. 10.00
 29. 5.00
 30. 10.00
 31. 15.00
 32. 10.00
 33. 5.00
 34. 10.00
 35. 15.00
 36. 10.00
 37. 5.00
 38. 10.00
 39. 15.00
 40. 10.00
 41. 5.00
 42. 10.00
 43. 15.00
 44. 10.00
 45. 5.00
 46. 10.00
 47. 15.00
 48. 10.00
 49. 5.00
 50. 10.00
 51. 15.00
 52. 10.00
 53. 5.00
 54. 10.00
 55. 15.00
 56. 10.00
 57. 5.00
 58. 10.00
 59. 15.00
 60. 10.00
 61. 5.00
 62. 10.00
 63. 15.00
 64. 10.00
 65. 5.00
 66. 10.00
 67. 15.00
 68. 10.00
 69. 5.00
 70. 10.00
 71. 15.00
 72. 10.00
 73. 5.00
 74. 10.00
 75. 15.00
 76. 10.00
 77. 5.00
 78. 10.00
 79. 15.00
 80. 10.00
 81. 5.00
 82. 10.00
 83. 15.00
 84. 10.00
 85. 5.00
 86. 10.00
 87. 15.00
 88. 10.00
 89. 5.00
 90. 10.00
 91. 15.00
 92. 10.00
 93. 5.00
 94. 10.00
 95. 15.00
 96. 10.00
 97. 5.00
 98. 10.00
 99. 15.00
 100. 10.00

羅基以內運費核算

| | | |
|--------------------|--------|--------|
| 自羅基至伯利地費 (20噸) | 100.00 | 70.00 |
| 全上十五日石馬路郵 (1/16) | 75.00 | 60.00 |
| 全上 運費物雜費 | 50.00 | 30.00 |
| 伯利地至十日石馬路郵費 (1/16) | 75.00 | 60.00 |
| 全上 運費代 | 170.00 | 275.00 |
| 全上 被服雜物等 | 180.00 | 245.00 |
| 全上 修補及運費等 | 10.00 | 2.00 |
| 650.00 | | 818.00 |

| | | |
|--------------------|-------|---------|
| 自伯利地至巴里地費 | 40.00 | 50.00 |
| 全上十日石馬路郵費 (3/16) | 25.00 | 2.00 |
| 全上 雜費 | 15.00 | 2.50 |
| 巴里地至十日石馬路郵費 (2/16) | 50.00 | 2.60.00 |
| 全上 運費雜費等 (1/16) | 80.00 | 70.00 |
| 560.00 | | 1032.00 |

| | | |
|--------------------|--------|-------|
| 自巴里地至倫敦運費及雜費 (100) | 20.00 | 20.00 |
| 倫敦至在十日石馬路 (1/16) | 50.00 | |
| 全上 雜費 | 30 | |
| 全上 運費 雜費等 | 100.00 | |
| 180.00 | | |

| | | |
|--------------------|---------|--|
| 自倫敦至新加坡運費 (1/16) | 150.00 | |
| 紅中雜費 | 30.00 | |
| 新加坡至三日石 (1/16) | 36.00 | |
| 全上 運費 | 30.00 | |
| 自新加坡至暹羅運費 (100) | 10.00 | |
| 暹羅快馬在二日石 (1/16) | 50.00 | |
| 全上 雜費 | 15.00 | |
| 自暹羅至香港運費 (1/16) | 200.00 | |
| 香港快馬在五日石 (1/16) | 35.00 | |
| 全上 雜費 | 80.00 | |
| 自香港至廈門 (郵費) (1/16) | 50.00 | |
| 合計 | 1250.00 | |

羅基以外運費收入核算

| | |
|------------|--------|
| 羅基出費/羅基運費 | 250.00 |
| 伯利地運費/40 | 800.00 |
| 倫敦運費/40 | 200.00 |
| 香港運費/40 | 700.00 |
| 1750.00 | |
| - 1500.00 | |
| 現 現現 (雜備費) | 164.00 |
| | 1.39 |

| | | |
|--------------|------------|---------------|
| 3 30 號 9. 50 | 10 號 9. 50 | Friendship B. |
| 3 31 號 9. 42 | Columbus | |
| 0 10 45 | 0 10 | |
| 4 1 號 9. 30 | Paris 局 | |
| 4 5 30 | 10 3. 45 | } 是 |
| 0 9. 50 | 0 9. 50 | |
| 0 11. 35 | 0 6. 45 | |
| 0 2. 40 | 0 10. 45 | |
| 0 9. 40 | 0 5. 40 | |

日午長地平結溫取

| | | | |
|------|------|----|------|
| 島春北島 | 22.5 | 甲府 | 13.2 |
| 島北島 | 24.5 | 根岸 | 14.2 |
| 島北島 | 21.5 | 新井 | 12.9 |
| 島北島 | 23.4 | 新井 | 12.2 |
| 島北島 | 22.0 | 福金 | 13.9 |
| 島北島 | 20.8 | 福金 | 15.1 |
| 島北島 | 16.8 | 福金 | 12.7 |
| 島北島 | 15.9 | 福金 | 12.1 |
| 島北島 | 15.5 | 福金 | 12.6 |
| 島北島 | 15.9 | 福金 | 11.8 |
| 島北島 | 15.9 | 福金 | 12.7 |
| 島北島 | 15.3 | 福金 | 11.0 |
| 島北島 | 15.3 | 福金 | 12.0 |
| 島北島 | 14.6 | 福金 | 11.3 |
| 島北島 | 14.5 | 福金 | 9.1 |
| 島北島 | 14.8 | 福金 | 8.9 |
| 島北島 | 13.7 | 福金 | 5.4 |
| 島北島 | 16.3 | 福金 | 4.8 |
| 島北島 | 15.1 | 福金 | 4.9 |
| 島北島 | 14.5 | 福金 | 4.6 |
| 島北島 | 14.2 | 福金 | 4.6 |
| 島北島 | 13.8 | 福金 | 4.6 |
| 島北島 | 14.3 | 福金 | 4.6 |
| 島北島 | 14.0 | 福金 | 4.6 |
| 島北島 | 13.2 | 福金 | 4.6 |
| 島北島 | 15.0 | 福金 | 4.6 |
| 島北島 | 16.1 | 福金 | 4.6 |
| 島北島 | 14.5 | 福金 | 4.6 |
| 島北島 | 13.8 | 福金 | 4.6 |
| 島北島 | 15.9 | 福金 | 4.6 |
| 島北島 | 14.9 | 福金 | 4.6 |
| 島北島 | 15.6 | 福金 | 4.6 |

日中人口 (舊曆) (民國九年)

| | | | |
|-------|---------|-------|----------|
| ○ 東 東 | 2507255 | ○ 廣 島 | 1996948 |
| 大 阪 | 1047270 | 山 口 | 1010916 |
| ○ 大 阪 | 1815800 | 加 爾 山 | 676778 |
| 神 戶 | 1692350 | 德 島 | 706932 |
| ○ 大 阪 | 1826167 | 香 川 | 705790 |
| 長 崎 | 779286 | 廣 島 | 1032239 |
| ○ 大 阪 | 1779720 | 高 知 | 693929 |
| 崎 玉 | 1238749 | ○ 福 岡 | 1507218 |
| 千 葉 | 1208737 | 大 分 | 854281 |
| 茨 城 | 1177205 | 佐 賀 | 653853 |
| 福 木 | 711477 | 熊 本 | 1184172 |
| ○ 大 阪 | 757671 | ○ 家 鄉 | 501959 |
| 上 野 | 1043917 | 鹿 島 | 1101877 |
| ○ 大 阪 | 1792685 | ○ 津 島 | 975732 |
| 神 戶 | 1270876 | 北 海 道 | 1077280 |
| ○ 大 阪 | 791187 | 合 計 | 98321175 |
| 廣 島 | 719889 | | |
| 岐 阜 | 1017770 | | |
| 長 崎 | 1347151 | | |
| 宮 城 | 877277 | | |
| 德 島 | 1179024 | | |
| 香 川 | 746279 | | |
| 高 知 | 657587 | | |
| 山 形 | 877108 | | |
| 秋 田 | 635966 | | |
| 福 井 | 622275 | | |
| 石 川 | 762370 | | |
| 富 山 | 776521 | | |
| ○ 鳥 取 | 933721 | | |
| 島 根 | 729807 | | |
| 岡 山 | 1187103 | | |

日中大阪人口表 (民國九年十一月一日)

| | |
|-------|---------|
| ○ 大 阪 | 1803579 |
| 大 阪 | 785200 |
| 香 川 | 377967 |
| 廣 島 | 329775 |
| 高 知 | 289829 |
| 神 戶 | 283837 |
| 長 崎 | 151927 |
| 德 島 | 113875 |
| 山 口 | 77578 |
| 加 爾 山 | 23773 |
| 岡 山 | 30170 |
| 鹿 島 | 29796 |
| 福 岡 | 70147 |
| 小 樽 | 57361 |
| 德 島 | 62778 |
| 山 口 | 67708 |
| 高 知 | 62225 |
| 廣 島 | 53384 |
| 神 戶 | 58821 |
| 長 崎 | 55304 |
| 大 阪 | 55277 |
| 佐 賀 | 52667 |
| 香 川 | 56275 |
| 德 島 | 53629 |

Restoranti - Roma

Veneto, in compagnia

Sala Umberto, nella via
dei Condotti

Caracciolo, all'Esposizioni
via della Spina

Ca' d'Orto, in via
dei Condotti

Caracciolo, in via
dei Condotti

Albergo "La Pace"
Colonna Regina,
nella via Condotti.

Albergo "La Pace"
Colonna Regina

Albergo "La Pace"

1. Memorandum

2. Lettera al Cardinale (R)

3. Lettera al Cardinale

Hotel from Golden Bridge
 London
 H. Luffo. near Pantheon
 No. 21 Rue Garibaldi
 London

| | | |
|---------|---------------|---------|
| 1 | Yuden | = 1.000 |
| 2 | Yuden | = 1.000 |
| 3 | Yuden | = 1.000 |
| 4 | Yuden - Yuden | = 1.000 |
| 5 | Yuden | = 1.000 |
| 6 | Yuden | = 1.000 |
| 7 | Yuden | = 1.000 |
| 8 | Yuden | = 1.000 |
| 9 | Yuden | = 1.000 |
| 10 | Yuden | = 1.000 |
| 100 | sto | = 1.000 |
| 1000 | tyriza | = 1.000 |
| 1000000 | million | = 1.000 |

Yuden Karte post
 Hochane



C

A

B

管理の人

- 4 14
- 15
- 16
- 17 林道
- 18
- 19 田上
- 20
- 21
- 22
- 23
- 24
- 25
- 26
- 27
- 28
- 29
- 30
- 5 1 田上
- 2 田上
- 3 田上
- 4 田上

遺傳表

| | | | |
|-------|--|---|--|
| 2. 5 | 中村健次郎
伊原次郎
林本電夫
中村健
〃
〃 | 岡野女
Zophalane
加藤 昭
Narayan
文部省
中央官
子大 | 参
母
高
高
高
高
高 |
| 2. 18 | 中村健次郎
在休
Zophalane | 中村健次郎
子大 | 高
高 |
| 2. 17 | 岡野女
其原大三
長尾信太郎
山岡 | 3. 28
岡野女
金子
中村健次郎
村井 | 高
高
高
高 |
| 3. 1 | 竹内英一
伊原次郎
村井
中村健次郎
長尾 | 3. 31
中村健次郎
志田
中村健次郎
Zophalane | 高
高
高
高 |
| 3. 4 | 宗典 | 4. 6
10
11 | 高
高
高 |
| 3. 18 | 志田 | | 高 |
| 3. 17 | 伊原次郎
全
全
中村健次郎
林本電夫
其原大三
土居健一
中村健次郎
飯島
山岡 | | 高
高
高
高
高
高
高
高
高
高 |

遺傳表

| | | |
|----|---|---|
| 15 | 大野直太郎, 山田進(澤田勲) | 高 |
| 16 | — | 高 |
| 17 | 寺井末吉(殿) | 高 |
| 18 | 山岡健次郎, 村井健次郎(温泉) | 高 |
| 19 | — | 高 |
| 20 | — | 高 |
| 21 | — | 高 |
| 22 | 新井隆, 田田 | 高 |
| 23 | — | 高 |
| 24 | 新井隆, 新井隆 | 高 |
| 25 | 飯島 | 高 |
| 26 | — | 高 |
| 27 | — | 高 |
| 28 | — | 高 |
| 29 | — | 高 |
| 30 | 村井健次郎 | 高 |
| 31 | — | 高 |
| 4 | — | 高 |
| 5 | — | 高 |
| 6 | 岡野女, 山田進 | 高 |
| 7 | — | 高 |
| 8 | — | 高 |
| 9 | 中村健次郎母上, (村井健次郎母上) | 高 |
| 10 | — | 高 |
| 11 | 中村健次郎母上, 父上 | 高 |
| 12 | — | 高 |
| 13 | 母上, 父上, 中村健次郎母上, 村井健次郎母上, 全
全次女, 全次男 | 高 |
| 14 | — | 高 |

3/16 伊东流傳 (連帖)
 17 土 破瓦
 金 平丸
 村三之雄丸
 向政日平丸
 山田寅次郎
 林屋常吉
 中村吾三
 古岡千代吉
 吉岡然次
 伊原松雄 (連書)
 逢中雄 (○)
 3/18 中田寅次郎 (連)
 渡辺海太郎
 山田寅次郎
 伊原松雄
 金 地債
 3/18 伊原流傳 快
 金 地債
 村三之雄丸
 山田寅次郎
 古岡千代吉
 中村文三
 森本大三
 3/20 領葛尾村 (連)
 夫松丸
 渡辺海太郎
 山田寅次郎
 伊原流傳
 藤丸
 金 平丸

松平新亮 (連書)
 湖中風樓
 中村亮三
 林 宗之丞
 吉岡千代吉
 大徳八郎 (連書)
 村三之雄丸
 渡辺海太郎 (連書)
 保岡勝也 (連書)
 山田寅次郎
 加藤切
 小野照平 (連書)
 六合寺
 菊坂時次郎
 土居絶一
 中村松次郎
 森本大三
 3/25 中火丸座 (連)
 山田寅次郎
 伊原松雄
 入野忠友
 伊原流傳
 金 平丸
 3/27 山田寅次郎 (連書)
 洋風丸
 伊原松雄
 金 平丸
 村三之雄丸
 金子堂

林平亮
 中村亮三
 山田寅次郎
 伊原松雄
 伊原流傳
 3/31 山田寅次郎 (連書)
 洋風丸
 保岡勝也
 中村松次郎
 金子堂
 藤本松次郎
 3/1 藤本松次郎 (連書)
 中村亮三
 伊原流傳
 金 地債
 中井 研
 田 行嘉流
 伊原流傳
 金 地債
 金 平丸
 村三之雄丸
 吉岡千代吉
 山田寅次郎
 森本大三

林平亮 (連書)
 中村亮三
 中村松次郎
 中村松次郎
 原野松次郎
 藤本松次郎
 山田寅次郎
 竹山正男
 原野松次郎
 村三之雄丸
 保岡勝也
 中井松次郎
 伊原松雄
 金 地債
 金 平丸
 3/12 藤本松次郎 (連書)
 竹山正男
 中井 研
 3/17 村三之雄丸 (連書)
 伊原流傳
 藤丸
 山田寅次郎
 小野照平
 林屋常吉
 吉岡千代吉
 山田寅次郎

| 月日 | 1851 日表 | 日 | 1852 |
|-------|----------------|----|------|
| 1. 25 | Comt. - Jurgon | 2 | 27 |
| 25 | Amoyra-Porale | 25 | 27 |
| 26 | Athen | 26 | 27 |
| 27 | " | 27 | 27 |
| 28 | " | 28 | 27 |
| 29 | " | 29 | 27 |
| 30 | " | 30 | 27 |
| 31 | " | 31 | 27 |
| 2 | " | 1 | 28 |
| 3 | " | 2 | 28 |
| 4 | " | 3 | 28 |
| 5 | Coronal | 4 | 28 |
| 6 | " | 5 | 28 |
| 7 | Olympia | 6 | 28 |
| 8 | " | 7 | 28 |
| 9 | Patras-Corin | 8 | 28 |
| 10 | Gips-Bindian | 9 | 28 |
| 11 | Napoli | 10 | 28 |
| 12 | " | 11 | 28 |
| 13 | " | 12 | 28 |
| 14 | " | 13 | 28 |
| 15 | " | 14 | 28 |
| 16 | " | 15 | 28 |
| 17 | " | 16 | 28 |
| 18 | " | 17 | 28 |
| 19 | " | 18 | 28 |
| 20 | " | 19 | 28 |
| 21 | " | 20 | 28 |
| 22 | " | 21 | 28 |
| 23 | " | 22 | 28 |
| 24 | " | 23 | 28 |
| 25 | " | 24 | 28 |
| 26 | " | 25 | 28 |
| 27 | " | 26 | 28 |
| 28 | " | 27 | 28 |
| 29 | " | 28 | 28 |
| 30 | " | 29 | 28 |
| 31 | " | 30 | 28 |
| 1 | " | 31 | 28 |
| 2 | " | 1 | 29 |
| 3 | " | 2 | 29 |
| 4 | " | 3 | 29 |
| 5 | " | 4 | 29 |
| 6 | " | 5 | 29 |
| 7 | " | 6 | 29 |
| 8 | " | 7 | 29 |
| 9 | " | 8 | 29 |
| 10 | " | 9 | 29 |
| 11 | " | 10 | 29 |
| 12 | " | 11 | 29 |
| 13 | " | 12 | 29 |
| 14 | " | 13 | 29 |
| 15 | " | 14 | 29 |
| 16 | " | 15 | 29 |
| 17 | " | 16 | 29 |
| 18 | " | 17 | 29 |
| 19 | " | 18 | 29 |
| 20 | " | 19 | 29 |
| 21 | " | 20 | 29 |
| 22 | " | 21 | 29 |
| 23 | " | 22 | 29 |
| 24 | " | 23 | 29 |
| 25 | " | 24 | 29 |
| 26 | " | 25 | 29 |
| 27 | " | 26 | 29 |
| 28 | " | 27 | 29 |
| 29 | " | 28 | 29 |
| 30 | " | 29 | 29 |
| 31 | " | 30 | 29 |
| 1 | " | 31 | 29 |
| 2 | " | 1 | 30 |
| 3 | " | 2 | 30 |
| 4 | " | 3 | 30 |
| 5 | " | 4 | 30 |
| 6 | " | 5 | 30 |
| 7 | " | 6 | 30 |
| 8 | " | 7 | 30 |
| 9 | " | 8 | 30 |
| 10 | " | 9 | 30 |
| 11 | " | 10 | 30 |
| 12 | " | 11 | 30 |
| 13 | " | 12 | 30 |
| 14 | " | 13 | 30 |
| 15 | " | 14 | 30 |
| 16 | " | 15 | 30 |
| 17 | " | 16 | 30 |
| 18 | " | 17 | 30 |
| 19 | " | 18 | 30 |
| 20 | " | 19 | 30 |
| 21 | " | 20 | 30 |
| 22 | " | 21 | 30 |
| 23 | " | 22 | 30 |
| 24 | " | 23 | 30 |
| 25 | " | 24 | 30 |
| 26 | " | 25 | 30 |
| 27 | " | 26 | 30 |
| 28 | " | 27 | 30 |
| 29 | " | 28 | 30 |
| 30 | " | 29 | 30 |
| 31 | " | 30 | 30 |
| 1 | " | 31 | 30 |
| 2 | " | 1 | 31 |
| 3 | " | 2 | 31 |
| 4 | " | 3 | 31 |
| 5 | " | 4 | 31 |
| 6 | " | 5 | 31 |
| 7 | " | 6 | 31 |
| 8 | " | 7 | 31 |
| 9 | " | 8 | 31 |
| 10 | " | 9 | 31 |
| 11 | " | 10 | 31 |
| 12 | " | 11 | 31 |
| 13 | " | 12 | 31 |
| 14 | " | 13 | 31 |
| 15 | " | 14 | 31 |
| 16 | " | 15 | 31 |
| 17 | " | 16 | 31 |
| 18 | " | 17 | 31 |
| 19 | " | 18 | 31 |
| 20 | " | 19 | 31 |
| 21 | " | 20 | 31 |
| 22 | " | 21 | 31 |
| 23 | " | 22 | 31 |
| 24 | " | 23 | 31 |
| 25 | " | 24 | 31 |
| 26 | " | 25 | 31 |
| 27 | " | 26 | 31 |
| 28 | " | 27 | 31 |
| 29 | " | 28 | 31 |
| 30 | " | 29 | 31 |
| 31 | " | 30 | 31 |

Louis de Kopdarovich
 Consul Imp. Roy. d'Autriche Hongrie
 Constantinople.
 大坂今橋三丁目五番地 中村商店
 本町横町五丁目十四番地 利根屋
 山田屋 双都

Erma
 Buchterman, Berlin W.
 Kurfürstendamm 43.
 19号 5号 1号
 Habib Escham
 Directeur Général de Messie Imperial
 Ottomane Constantinople.

1851年10月15日 他日未定
 大坂今橋三丁目五番地 中村商店
 本町横町五丁目十四番地 利根屋

| | | | | | |
|----|---|----|---|----|---|
| 27 | + | 11 | + | 26 | + |
| 28 | + | 12 | + | 27 | + |
| 29 | + | 13 | + | 28 | + |
| 30 | + | 14 | + | 29 | + |
| 31 | + | 15 | + | 30 | + |
| 1 | + | 16 | + | 31 | + |
| 2 | + | 17 | + | 1 | + |
| 3 | + | 18 | + | 2 | + |
| 4 | + | 19 | + | 3 | + |
| 5 | + | 20 | + | 4 | + |
| 6 | + | 21 | + | 5 | + |
| 7 | + | 22 | + | 6 | + |
| 8 | + | 23 | + | 7 | + |
| 9 | + | 24 | + | 8 | + |
| 10 | + | 25 | + | 9 | + |
| 11 | + | 26 | + | 10 | + |
| 12 | + | 27 | + | 11 | + |
| 13 | + | 28 | + | 12 | + |
| 14 | + | 29 | + | 13 | + |
| 15 | + | 30 | + | 14 | + |
| 16 | + | 31 | + | 15 | + |
| 17 | + | 1 | + | 16 | + |
| 18 | + | 2 | + | 17 | + |
| 19 | + | 3 | + | 18 | + |
| 20 | + | 4 | + | 19 | + |
| 21 | + | 5 | + | 20 | + |
| 22 | + | 6 | + | 21 | + |
| 23 | + | 7 | + | 22 | + |
| 24 | + | 8 | + | 23 | + |
| 25 | + | 9 | + | 24 | + |
| 26 | + | 10 | + | 25 | + |
| 27 | + | 11 | + | 26 | + |
| 28 | + | 12 | + | 27 | + |
| 29 | + | 13 | + | 28 | + |
| 30 | + | 14 | + | 29 | + |
| 31 | + | 15 | + | 30 | + |
| 1 | + | 16 | + | 31 | + |
| 2 | + | 17 | + | 1 | + |
| 3 | + | 18 | + | 2 | + |
| 4 | + | 19 | + | 3 | + |
| 5 | + | 20 | + | 4 | + |
| 6 | + | 21 | + | 5 | + |
| 7 | + | 22 | + | 6 | + |
| 8 | + | 23 | + | 7 | + |
| 9 | + | 24 | + | 8 | + |
| 10 | + | 25 | + | 9 | + |
| 11 | + | 26 | + | 10 | + |
| 12 | + | 27 | + | 11 | + |
| 13 | + | 28 | + | 12 | + |
| 14 | + | 29 | + | 13 | + |
| 15 | + | 30 | + | 14 | + |
| 16 | + | 31 | + | 15 | + |
| 17 | + | 1 | + | 16 | + |
| 18 | + | 2 | + | 17 | + |
| 19 | + | 3 | + | 18 | + |
| 20 | + | 4 | + | 19 | + |
| 21 | + | 5 | + | 20 | + |
| 22 | + | 6 | + | 21 | + |
| 23 | + | 7 | + | 22 | + |
| 24 | + | 8 | + | 23 | + |
| 25 | + | 9 | + | 24 | + |
| 26 | + | 10 | + | 25 | + |
| 27 | + | 11 | + | 26 | + |
| 28 | + | 12 | + | 27 | + |
| 29 | + | 13 | + | 28 | + |
| 30 | + | 14 | + | 29 | + |
| 31 | + | 15 | + | 30 | + |

12

5 15

23
27
26
28
26 12
H. H. H. H. H.

持
研
田
中

希臘、伊太利、獨佛、第十三冊

明治三十八年自二月至四月

希臘、伊太利、獨佛、第十三冊

Der Stier.

Der Mond.

Sei es in oder außer dem Hause, so
 werden Sie beständig die Personen, mit
 welchen Sie Umgang haben, denn Sie
 könnten selbst von Dergleichen, welche
 Ihnen schmeicheln, betrogen werden; aber
 Sie müssen sich auch nicht mit ihnen ein-
 lassen: Aber Rathszeit kündigt Ihnen
 den Sieg über Ihre Feinde überall an;
 Sie werden überrascht werden. Sie werden
 bald zu einem Erbtheil gelangen, welches
 Sie nicht erwarteten, und eine Summe
 Geld erhalten, welche Ihnen Freude
 machen wird; dieses Geld gewinnt anderes,
 und ohne daran zu denken, werden Sie
 zu großen Gütern gelangen.

Sie haben bis dahin viele Sorgen
 gehabt, aber jetzt werden Sie vom Glücke
 und auf überraschende Weise begünstigt
 werden und in der Folge weit mehr Glück
 haben, als bis jetzt.

Antwort.

Sie haben gute Geschäfte, was Sie aber nicht verhindert, Ihrem Geschäften Ehre zu machen. Sie erwarten Geld, wenn Sie nicht ungeduldig, Sie werden es bald erhalten. Der Allgütige Gott, Ihrem Geschäften Ehre zu machen, beherzigt Ihren Geist und will Sie eines von Vergnügungen, in welchen Sie Hierauf angesetzt werden, ab. So ruhig sein, Sie werden glücklicher sein als Sie denken. Ein unverändertes Erbe wird Sie in Wohlstand erheben. Aber Sie werden einen Preis bekommen, welcher Ansehen verursachen wird, bei oder bald in angenehmer Gesellschaft vertheilt, wo Sie Ihre Zeit anzuwenden pflichten können.

23, 25, 37, 62, 78.

Copyright 日本建築学会

CERTIFICATE OF POSTING OF A REGISTERED POSTAL PACKET.

A Postal Packet, addressed as usual, upon which a Fee of Two Pence has been paid, in addition to the Postage of _____ 4d has been registered and posted here this day:—

Postmaster
20 Rue des Capucines
Paris

Postmaster's Signature (or initials)

DATE STAMP



Copyright 日本建築学会

1981
The author is not responsible for the content of the text.
The author is not responsible for the content of the text.
The author is not responsible for the content of the text.
The author is not responsible for the content of the text.
The author is not responsible for the content of the text.

Copyright 日本建築学会

| | 冊 | 頁 | 冊 | 頁 | | |
|------|----|-----|-----|----|---|----|
| 4-20 | — | 7 | 第2卷 | — | 5 | 15 |
| — | 8 | 第2卷 | — | 6 | | |
| — | 15 | 第2卷 | — | 23 | | |
| — | 17 | 第2卷 | — | 27 | | |
| — | 23 | 第2卷 | — | 26 | | |
| — | 26 | 第2卷 | — | 2 | | |
| — | 26 | 第2卷 | — | 12 | | |

Copyright 日本建築学会

| | | | |
|---|---------------------------|-------|----------|
| ① | May 10. Camp. of India X | | Yokohama |
| | May 24. Siberia | | June 5 |
| | June 2. Mongolia | ----- | June 18. |
| ② | June 12. Camp. of Japan X | ----- | June 22. |
| | June 13. China | | June 26. |
| | London - Yokohama | | July 2. |
| | | | 400. |